



Metal pipe systems



System information

More effective work with precision steel pipes

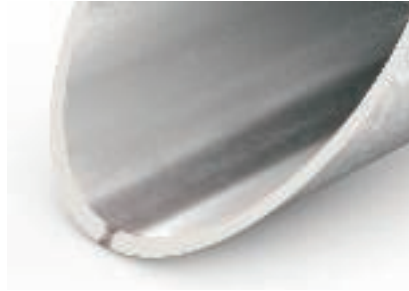
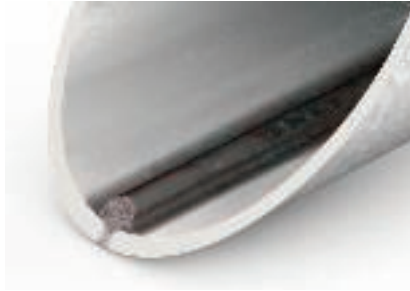

Structure with weld seam area, not scraped



Structure with weld seam area, scraped

Increased precision, simpler installation

When producing steel pipes, the machining process creates a bulge along the welding seam.

The OBO precision steel pipes have the annoying bulge removed directly after welding. This means that the inside of the pipes is completely smooth – and cables can be pushed through without any problems. This saves the installation engineer valuable time.

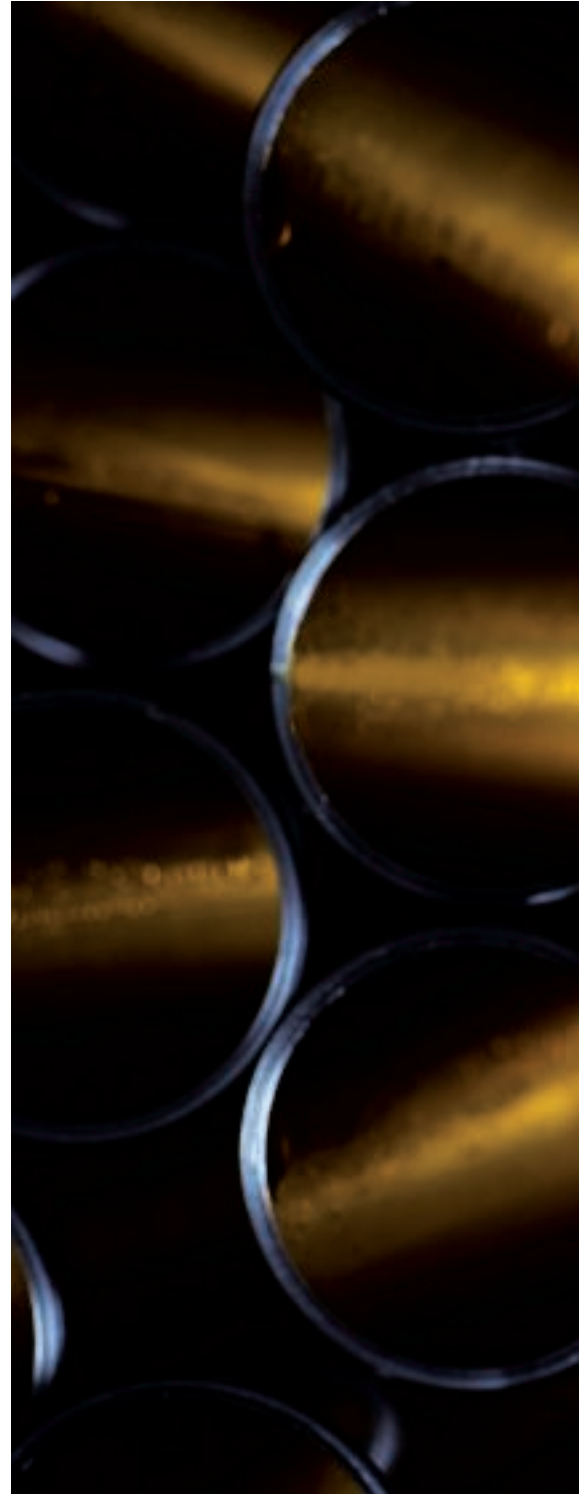

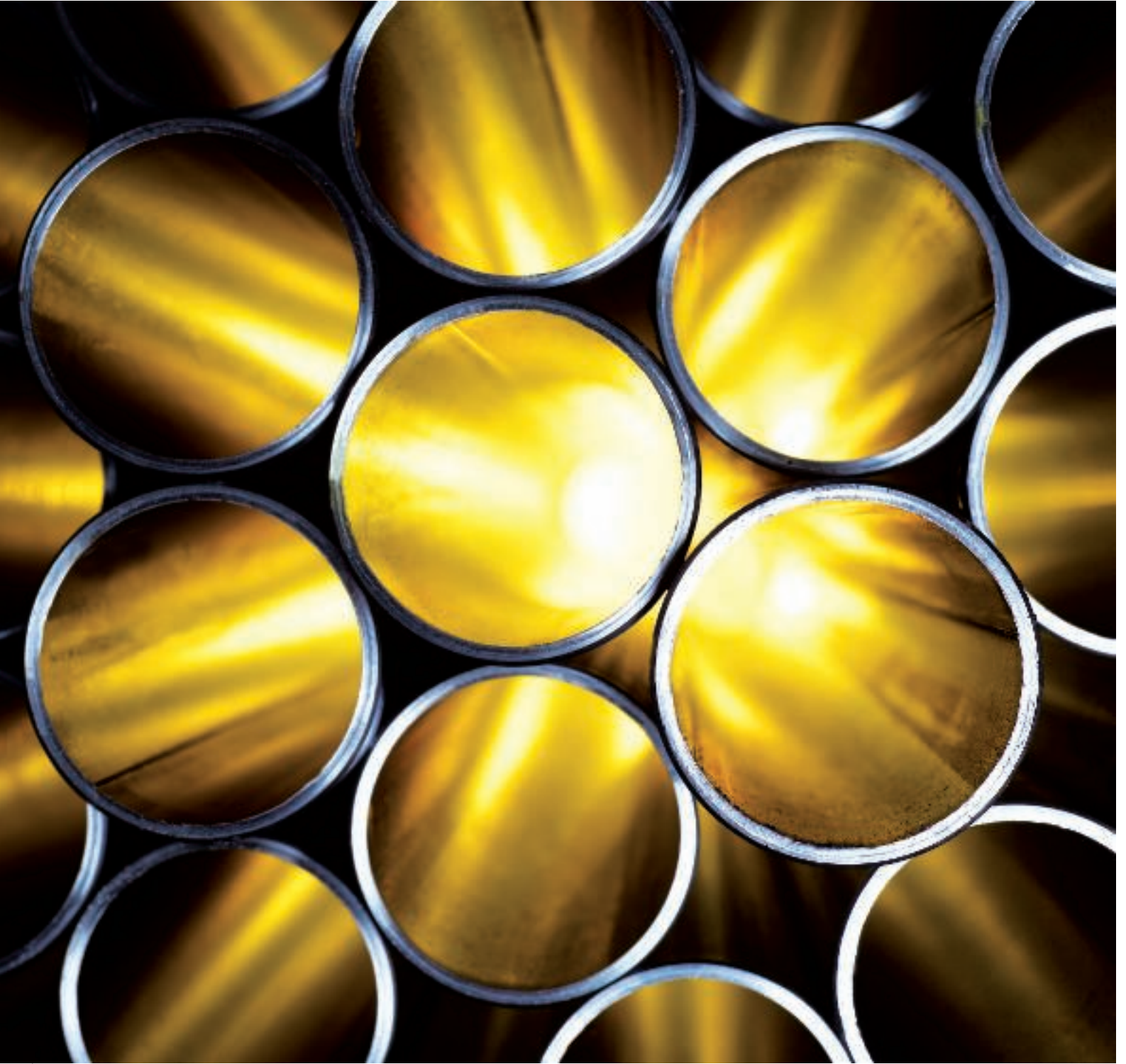

Basic principles of the IEC classification of pipe systems

The OBO Bettermann pipe systems are machined and tested according to IEC EN 61386 "Conduit systems for cable management" and IEC EN 60423 "Conduit sys-

tems for cable management - Outside diameters of conduits for electrical installations and threads for conduits and fittings".

IEC EN 61386

Standard	Contents
EN 61386-1	General requirements
EN 61386-21	Particular requirements - Rigid conduit systems
EN 61386-22	Particular requirements - Pliable conduit systems
EN 61386-23	Particular requirements - Flexible conduit systems
EN 61386-24	Particular requirements - Conduit systems buried underground
EN 61386-25	Particular requirements - Conduit fixing devices

Classification according to IEC EN 61386-1 – Part 1: General requirements

Digit	Contents
1st digit	Resistance to compression
2nd digit	Resistance to impact
3rd digit	Lower temperature range
4th digit	Upper temperature range
5th digit	Resistance to bending
6th digit	Electrical characteristics
7th digit	Resistance against ingress of solid objects
8th digit	Resistance against ingress of water
9th digit	Resistance against corrosion
10th digit	Tensile strength
11th digit	Resistance to flame propagation
12th digit	Suspended load capacity

IEC classification 1st to 5th digit as numeric code on the product

Numeric code

You can find the first five digits in the product descriptions of the pipe systems. The table below provides an overview of the different meanings of the numbers.



Numeric code on the product

Classification code according to IEC EN 61386: With application example (orange)

	First digit		Second digit		Third digit		Fourth digit		Fifth digit
	Resistance to compression		Resistance to impact		Lower temperature range		Upper temperature range		Resistance to bending
1	Very light (125 N)	1	Very light (0.5 kg/100 mm)	1	+ 5 °C	1	+ 60 °C	1	Rigid
2	Light (320 N)	2	Light (1.0 kg/100 mm)	2	- 5 °C	2	+ 90 °C	2	Pliable
3	Medium (750 N)	3	Medium (2.0 kg/100 mm)	3	- 15 °C	3	+ 105 °C	3	Pliable, self-recovering
4	Heavy (1,250 N)	4	Heavy (2.0 kg/300 mm)	4	- 25 °C	4	+ 120 °C	4	Flexible
5	Very heavy (4000 N)	5	Very heavy (6.8 kg/300 mm)	5	- 45 °C	5	+ 150 °C		
						6	+ 250 °C		
						7	+ 400 °C		

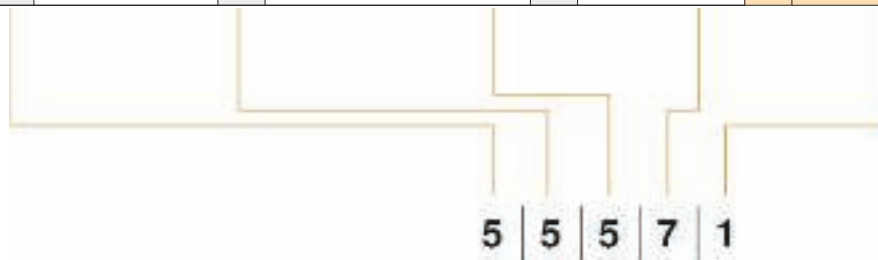

IEC classification 7th to 9th digit

Classification according to IEC EN 61386-1: Combination of the IP code

7th digit		8th digit	
Ingress of solid objects		Ingress of water	
0		0	None specified
1		1	Protected against vertically falling water drops
2		2	Protected against vertically falling water drops, when the conduit system is tilted up to an angle of 15°
3	Protected against solid foreign objects of 2.5 mm Ø and greater	3	Protected against spraying water
4	Protected against solid foreign objects of 1.0 mm Ø and greater	4	Protected against splashing water
5	Dust-protected	5	Protected against water jets
6	Dust-tight	6	Protected against powerful water jets
7		7	Protected against the effects of temporary immersion in water



IP code: 5 2

Classification according to IEC EN 61386-1: Corrosion protection

9th digit		Suitable surfaces
Resistance against corrosion		
1	Low protection, inside and outside	
2	Medium protection, inside and outside	<ul style="list-style-type: none"> • Painted black (SW) • Electrogalvanised (G) • Strip galvanised (FS)
3	Medium protection inside, high protection outside	
4	High protection, inside and outside	<ul style="list-style-type: none"> • Hot-dip galvanised (FT) • Stainless steel (V2A, V4A)

Mechanical load and function maintenance in case of fire



Protection against mechanical loads

OBO metal pipes are particularly suited to use under tough industrial conditions. They provide reliable protection against very heavy mechanical loads during cable routing.

The different material and surface qualities, from galvanised to painted, allow perfect adaptation to the requirements of the appropriate environment.

Function maintenance E30/E90

Our steel pipes guarantee function maintenance to E30/E90. They are thus ideal for the connection of safety-relevant equipment, such as fire alarm systems.

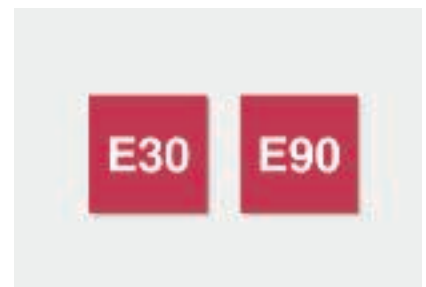

OBO steel pipes and their classification

Overview

You can obtain the precision steel pipes as threaded and plug-in pipes, hot-dip galvanised, painted and electrogalvanised. The product range is completed with bends and couplings. Of course, they are also compatible with the entire OBO accessories range.



Classification of the steel pipes according to IEC EN 61386: Certification according to VDE

Product	Type	1st digit	2nd digit	3rd digit	4th digit	5th digit	6th digit
		Compression resistance	Resistance to impact	Lower temperature range	Upper temperature range	Bending resistance	Electrical character
Plug-in steel pipe, painted black	S...W SW	4 Heavy (1,250 N)	4 Heavy (2.0 kg/300 mm)	5 - 45 °C	6 + 250 °C	1 Rigid	0 None decl
Plug-in steel pipe, electrogalvanised	S...W G	4 Heavy (1,250 N)	4 Heavy (2.0 kg/300 mm)	5 - 45 °C	7 + 400 °C	1 Rigid	1 With elect continuity characteri
Plug-in steel pipe, hot-dip galvanised	S...W FT	4 Heavy (1,250 N)	4 Heavy (2.0 kg/300 mm)	5 - 45 °C	7 + 400 °C	1 Rigid	1 With elect continuity characteri
Threaded steel pipe, painted black	SM...W SW	5 Very heavy (4,000 N)	5 Very heavy (6.8 kg/300 mm)	5 - 45 °C	6 + 250 °C	1 Rigid	1 With elect continuity characteri
Threaded steel pipe, electrogalvanised	SM...W G	5 Very heavy (4,000 N)	5 Very heavy (6.8 kg/300 mm)	5 - 45 °C	7 + 400 °C	1 Rigid	1 With elect continuity characteri
Threaded steel pipe, hot-dip galvanised	SM...W FT	5 Very heavy (4,000 N)	5 Very heavy (6.8 kg/300 mm)	5 - 45 °C	7 + 400 °C	1 Rigid	1 With elect continuity characteri



6th digit	7th digit	8th digit	9th digit	10th digit	11th digit	12th digit
Technical characteristics	Ingress of solid objects	Ingress of water	Resistance against corrosion	Tensile strength	Resistance to flame propagation	Suspended load capacity
None declared	4 Protected against solid foreign objects of 1.0 mm Ø and greater	0 None declared	2 Medium protection, inside and outside	0 None declared	1 Non-flame propagating	0 None declared
Electrical continuity characteristics	4 Protected against solid foreign objects of 1.0 mm Ø and greater	0 None declared	2 Medium protection, inside and outside	0 None declared	1 Non-flame propagating	0 None declared
Electrical continuity characteristics	4 Protected against solid foreign objects of 1.0 mm Ø and greater	0 None declared	4 High protection, inside and outside	0 None declared	1 Non-flame propagating	0 None declared
Electrical continuity characteristics	5 Dust-protected	2 Protected against vertically falling water drops, tilted up to 15°	2 Medium protection, inside and outside	0 None declared	1 Non-flame propagating	0 None declared
Electrical continuity characteristics	5 Dust-protected	2 Protected against vertically falling water drops, tilted up to 15°	2 Medium protection, inside and outside	0 None declared	1 Non-flame propagating	0 None declared
Electrical continuity characteristics	5 Dust-protected	2 Protected against vertically falling water drops, tilted up to 15°	4 High protection, inside and outside	0 None declared	1 Non-flame propagating	0 None declared

Electrogalvanised steel pipes



Electrogalvanised steel pipe, with thread



Type	Thread	Dimension D mm	Dimension L mm	Dimension l mm	Dimension t mm	Pack. m	Weight kg/100 m	Item No.
SM16W G	M16 x 1.5	16	3000	12.5	1.4	30	50.390	2046 86 1
SM20W G	M20 x 1.5	20	3000	15	1.6	30	72.570	2046 86 2
SM25W G	M25 x 1.5	25	3000	18	1.6	30	92.290	2046 86 3
SM32W G	M32 x 1.5	32	3000	20	1.6	21	120.000	2046 86 4
SM40W G	M40 x 1.5	40	3000	22	1.6	15	151.450	2046 86 5
SM50W G	M50 x 1.5	50	3000	26	1.6	15	190.000	2046 86 6
SM63W G	M63 x 1.5	63	3000	26	1.8	9	287.700	2046 86 7

St Steel **G** Electrogalvanised

Electrical installation pipe according to EN 61386-1 with threaded ends to EN 60423 for mechanical protection of cables.

With burr-free inner wall. One coupling is already screwed onto each pipe.

5 | 5 | 5 | 7 | 1

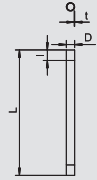

Electrogalvanised steel bend, with thread



Type	Thread	Dimension A mm	Dimension B mm	Dimension D mm	Dimension l mm	Dimension R mm	Dimension t mm	Pack. pcs	Weight kg/100 pcs.	Item No.
SBNM16 G	M16 x 1.5	45	103	16	13	50	1.4	15	10.400	2046 77 8
SBNM20 G	M20 x 1.5	55	155	20	13	90	1.6	25	21.000	2046 77 9
SBNM25 G	M25 x 1.5	68	190	25	18	110	1.6	25	33.000	2046 78 0
SBNM32 G	M32 x 1.5	88	254	32	18	150	1.6	20	56.600	2046 78 1
SBNM40 G	M40 x 1.5	89	279	40	20.5	170	1.6	15	77.600	2046 78 2
SBNM50 G	M50 x 1.5	133	358	50	25	200	1.6	5	125.800	2046 78 3
SBNM63 G	M63 x 1.5	165	446	63	25	250	1.8	3	227.000	2046 78 4

St Steel **G** Electrogalvanised

90° bend for electrical installation pipes according to EN 61386-1 with threaded ends to DIN EN 60423. With burr-free inner wall. One connection sleeve is already screwed onto each pipe bend.

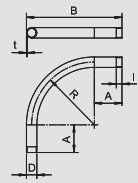

Electrogalvanised steel coupling, with thread



Type	Thread	Dimension D mm	Dimension d mm	Dimension L mm	Dimension t mm	Pack. pcs	Weight kg/100 pcs.	Item No.
SVM16W G	M16 x 1.5	18.5	16	26	2	25	2.110	2046 87 5
SVM20W G	M20 x 1.5	22.5	20	30	2	50	3.030	2046 87 6
SVM25W G	M25 x 1.5	27.5	25	40	2	50	5.030	2046 87 7
SVM32W G	M32 x 1.5	35.5	32	40	2.5	50	8.130	2046 87 8
SVM40W G	M40 x 1.5	43.5	40	45	2.5	25	11.370	2046 87 9
SVM50W G	M50 x 1.5	53.5	50	54	2.5	10	16.970	2046 88 0
SVM63W G	M63 x 1.5	68	63	60	3.2	5	30.670	2046 88 1

St Steel **G** Electrogalvanised

Accessory part: pipe connection sleeve with thread to DIN EN 60423 to connect electrical installation pipes and 90° bends.

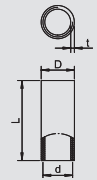

Electrogalvanised steel pipes



Electrogalvanised steel pipe, without thread



Type	Dimension D mm	Dimension L mm	Dimension t mm		Pack.	Weight	Item No.
					m	kg/100 m	
S16W G	16	3000	1		30	37.000	2046 84 0
S20W G	20	3000	1		30	46.900	2046 84 1
S25W G	25	3000	1.2		30	70.400	2046 84 2
S32W G	32	3000	1.2		21	91.100	2046 84 3
S40W G	40	3000	1.2		15	114.780	2046 84 4
S50W G	50	3000	1.2		15	144.000	2046 84 5
S63W G	63	3000	1.2		9	227.500	2046 84 6



St Steel **G** Electrogalvanised

Electrical installation pipe without threaded ends according to EN 61386-1 for mechanical protection of cables. With burr-free inner wall.

4 | 4 | 5 | 7 | 1

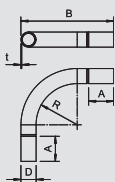

Electrogalvanised steel bend, without thread



Type	Dimension A mm	Dimension B mm	Dimension D mm	Dimension l mm	Dimension R mm	Dimension t mm		Pack.	Weight	Item No.
								pcs	kg/100 pcs.	
SBN16 G	43.7	103	18.6	25	50	1		15	7.200	2046 80 8
SBN20 G	53.7	155	22.6	30	90	1		25	13.300	2046 80 9
SBN25 G	66.5	190	28	40	110	1.2		25	24.400	2046 81 0
SBN32 G	86.5	254	35.1	40	150	1.2		20	41.000	2046 81 1
SBN40 G	87.2	279	43.7	50	170	1.5		15	68.900	2046 81 2
SBN50 G	131	358	54	60	200	1.5		5	111.800	2046 81 3
SBN63 G	163	446	67	90	250	1.5		3	174.200	2046 81 4



St Steel **G** Electrogalvanised

90° bend with moulded sleeves, for electrical installation pipes according to EN 61386-1. With burr-free inner wall.

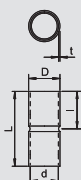

Electrogalvanised steel coupling, without thread



Type	Dimension D mm	Dimension d mm	Dimension L mm	Dimension l mm	Dimension t mm		Pack.	Weight	Item No.
							pcs	kg/100 pcs.	
SV16W G	18.6	16.6	50	25	1		25	2.200	2046 85 4
SV20W G	23.1	20.7	60	30	1.2		50	3.200	2046 85 5
SV25W G	28.1	25.7	60	30	1.2		50	5.600	2046 85 6
SV32W G	35.2	32.8	70	35	1.2		50	7.100	2046 85 7
SV40W G	43.8	43.8	80	40	1.5		25	12.500	2046 85 8
SV50W G	54	51	100	50	1.5		10	19.400	2046 85 9
SV63W G	67	64	100	50	1.5		5	24.300	2046 86 0



St Steel **G** Electrogalvanised

Accessory part: plug-in sleeve for the connections between electrical installation pipes. With burr-free inner wall.

Black painted steel pipes



Black painted steel pipe, with thread



Type	Thread	Dimension D mm	Dimension L mm	Dimension I mm	Dimension t mm	Colour	Pack. m	Weight kg/100 m	Item No.
SM16W SW	M16 x 1.5	16	3000	12.5	1.4	Black	30	50.000	2046 50 0
SM20W SW	M20 x 1.5	20	3000	15	1.6	Black	30	73.000	2046 50 1
SM25W SW	M25 x 1.5	25	3000	18	1.6	Black	30	92.000	2046 50 2
SM32W SW	M32 x 1.5	32	3000	20	1.6	Black	21	120.000	2046 50 3
SM40W SW	M40 x 1.5	40	3000	22	1.6	Black	15	152.000	2046 50 5
SM50W SW	M50 x 1.5	50	3000	26	1.6	Black	15	190.700	2046 50 6
SM63W SW	M63 x 1.5	63	3000	26	1.8	Black	9	287.700	2046 50 7

St Steel L Painted

Electrical installation pipe according to EN 61386-1 with threaded ends to EN 60423 for mechanical protection of cables.

With burr-free inner wall. One coupling is already screwed onto each pipe.

5 | 5 | 5 | 6 | 1

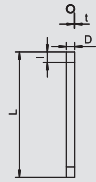

Black painted steel bend, with thread



Type	Thread	Dimension A mm	Dimension B mm	Dimension D mm	Dimension I mm	Dimension R mm	Dimension t mm	Pack. pcs	Weight kg/100 pcs.	Item No.
SBNM16 SW	M16 x 1.5	45	103	16	13	50	1.4	15	10.400	2046 79 3
SBNM20 SW	M20 x 1.5	55	155	20	13	90	1.6	25	21.000	2046 79 4
SBNM25 SW	M25 x 1.5	68	190	25	18	110	1.6	25	33.000	2046 79 5
SBNM32 SW	M32 x 1.5	88	254	32	18	150	1.6	20	56.600	2046 79 6
SBNM40 SW	M40 x 1.5	89	279	40	20.5	170	1.6	15	77.600	2046 79 7
SBNM50 SW	M50 x 1.5	133	358	50	25	200	1.6	5	125.800	2046 79 8
SBNM63 SW	M63 x 1.5	165	446	63	25	250	1.8	3	227.000	2046 79 9

St Steel G Electrogalvanised

90° bend for electrical installation pipes according to EN 61386-1 with threaded ends to DIN EN 60423. With burr-free inner wall. One connection sleeve is already screwed onto each pipe bend.

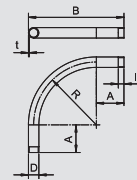

Black painted steel sleeve, with thread



Type	Thread	Dimension D mm	Dimension d mm	Dimension L mm	Dimension t mm	Colour	Pack. pcs	Weight kg/100 pcs.	Item No.
SVM16W SW	M16 x 1.5	18.5	16	26	2	Black	25	2.100	2046 52 2
SVM20W SW	M20 x 1.5	22.5	20	30	2	Black	50	3.000	2046 52 3
SVM25W SW	M25 x 1.5	27.5	25	40	2	Black	50	5.000	2046 52 4
SVM32W SW	M32 x 1.5	35.5	32	40	2.5	Black	50	8.100	2046 52 5
SVM40W SW	M40 x 1.5	43.5	40	45	2.5	Black	25	11.400	2046 52 6
SVM50W SW	M50 x 1.5	53.5	50	54	2.5	Black	10	17.000	2046 52 7
SVM63W SW	M63 x 1.5	68	63	60	3.2	Black	5	30.700	2046 52 8

St Steel L Painted

Accessory part: pipe connection sleeve with thread to DIN EN 60423 to connect electrical installation pipes and 90° bends.

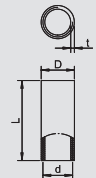



Black painted steel pipe, without thread



Type	Dimension D mm	Dimension L mm	Dimension t mm	Colour	Pack. m	Weight kg/100 m	Item No.
S16W SW	16	3000	1	Black	30	37.000	2046 56 5
S20W SW	20	3000	1	Black	30	47.000	2046 56 6
S25W SW	25	3000	1.2	Black	30	70.000	2046 56 7
S32W SW	32	3000	1.2	Black	21	91.000	2046 56 8
S40W SW	40	3000	1.2	Black	15	114.700	2046 56 9
S50W SW	50	3000	1.2	Black	15	144.000	2046 57 0
S63W SW	63	3000	1.2	Black	9	182.700	2046 57 1

St Steel **L** Painted

Electrical installation pipe without threaded ends according to EN 61386-1 for mechanical protection of cables. With burr-free inner wall.

4 | 4 | 5 | 6 | 1

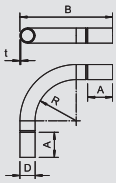

Black painted steel bend, without thread



Type	Dimension A mm	Dimension B mm	Dimension D mm	Dimension l mm	Dimension R mm	Dimension t mm	Colour	Pack. pcs	Weight kg/100 pcs.	Item No.
SBN16 SW	43.7	103	16.6	25	50	1	Black	15	7.200	2046 82 4
SBN20 SW	53.7	155	20.6	30	90	1	Black	25	13.300	2046 82 5
SBN25 SW	66.5	190	25.6	40	110	1.2	Black	25	24.400	2046 82 6
SBN32 SW	86.5	254	32.7	40	150	1.2	Black	20	41.000	2046 82 7
SBN40 SW	87.2	279	40.7	50	170	1.5	Black	15	68.900	2046 82 8
SBN50 SW	131	358	51	60	200	1.5	Black	5	111.800	2046 82 9
SBN63 SW	163	446	64	90	250	1.5	Black	3	174.200	2046 83 0

St Steel **G** Electrogalvanised

90° bend with moulded sleeves, for electrical installation pipes according to EN 61386-1. With burr-free inner wall.

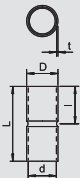

Black painted steel sleeve, without thread



Type	Dimension D mm	Dimension d mm	Dimension L mm	Dimension l mm	Dimension t mm	Colour	Pack. pcs	Weight kg/100 pcs.	Item No.
SV16W SW	18.6	16.6	50	25	1	Black	25	2.200	2046 58 2
SV20W SW	23.1	20.7	60	30	1.2	Black	50	3.200	2046 58 3
SV25W SW	28.1	25.7	60	30	1.2	Black	50	5.600	2046 58 4
SV32W SW	35.2	32.8	70	35	1.2	Black	50	7.100	2046 58 5
SV40W SW	43.8	40.8	80	40	1.5	Black	25	12.500	2046 58 6
SV50W SW	54	51	100	50	1.5	Black	10	19.400	2046 58 7
SV63W SW	67	64	100	50	1.5	Black	5	24.300	2046 58 8

St Steel **L** Painted

Accessory part: plug-in sleeve for the connections between electrical installation pipes. With burr-free inner wall.



Hot-dip galvanised steel pipes



Hot-dip galvanised steel pipe, with thread



Type	Thread	Dimension D mm	Dimension L mm	Dimension I mm	Dimension t mm	Pack. m	Weight kg/100 m	Item No.
SM16W FT	M16 x 1.5	16	3000	12.5	1.4	30	54.000	2046 53 3
SM20W FT	M20 x 1.5	20	3000	15	1.6	30	79.000	2046 53 4
SM25W FT	M25 x 1.5	25	3000	18	1.6	30	99.000	2046 53 5
SM32W FT	M32 x 1.5	32	3000	20	1.6	21	130.000	2046 53 6
SM40W FT	M40 x 1.5	40	3000	22	1.6	15	164.000	2046 53 7
SM50W FT	M50 x 1.5	50	3000	26	1.6	15	206.000	2046 53 8
SM63W FT	M63 x 1.5	63	3000	26	1.8	9	324.700	2046 54 0

St Steel **FT** Hot-dip galvanised

Electrical installation pipe according to EN 61386-1 with threaded ends to EN 60423 for mechanical protection of cables.
With burr-free inner wall. Corrosion protection class 4 (high). One connection sleeve is already screwed onto each pipe.

5 | 5 | 5 | 7 | 1

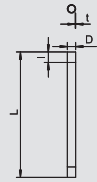

Hot-dip galvanised steel bend, with thread



Type	Thread	Dimension A mm	Dimension B mm	Dimension D mm	Dimension I mm	Dimension R mm	Dimension t mm	Pack. pcs	Weight kg/100 pcs.	Item No.
SBNM16 FT	M16 x 1.5	45	103	16	13	50	1.4	15	10.400	2046 78 6
SBNM20 FT	M20 x 1.5	55	155	20	13	90	1.6	25	21.000	2046 78 7
SBNM25 FT	M25 x 1.5	68	190	25	18	110	1.6	25	33.000	2046 78 8
SBNM32 FT	M32 x 1.5	88	254	32	18	150	1.6	20	56.600	2046 78 9
SBNM40 FT	M40 x 1.5	89	279	40	20.5	170	1.6	15	77.600	2046 79 0
SBNM50 FT	M50 x 1.5	133	358	50	25	200	1.6	5	125.800	2046 79 1
SBNM63 FT	M63 x 1.5	165	446	63	25	250	1.8	3	227.000	2046 79 2

St Steel **FT** Hot-dip galvanised

90° bend for electrical installation pipes according to EN 61386-1 with threaded ends to DIN EN 60423. With burr-free inner wall. One connection sleeve is already screwed onto each pipe bend.

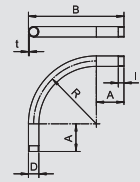

Zinc-nickel coated steel sleeve, with thread



Type	Thread	Dimension D mm	Dimension d mm	Dimension L mm	Dimension t mm	Pack. pcs	Weight kg/100 pcs.	Item No.
SVM16W DN	M16 x 1.5	18.5	16	26	2	25	2.100	2046 55 3
SVM20W DN	M20 x 1.5	22.5	20	30	2	50	3.000	2046 55 4
SVM25W DN	M25 x 1.5	27.5	25	40	2	50	3.986	2046 55 6
SVM32W DN	M32 x 1.5	35.5	32	40	2.5	50	8.100	2046 55 7
SVM40W DN	M40 x 1.5	43.5	40	45	2.5	25	11.400	2046 55 8
SVM50W DN	M50 x 1.5	53.5	50	54	2.5	10	17.000	2046 55 9
SVM63W DN	M63 x 1.5	68	63	60	3.2	5	30.700	2046 56 0

St Steel **DN** Zinc / nickel-coated

Accessory part: pipe connection sleeve with thread to DIN EN 60423 to connect electrical installation pipes and 90° bends.

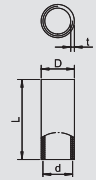

Hot-dip galvanised steel pipes



Hot-dip galvanised steel pipe, without thread



Type	Dimension D mm	Dimension L mm	Dimension t mm		Pack.	Weight	Item No.
					m	kg/100 m	
S16W FT	16	3000	1		30	40.000	2046 59 3
S20W FT	20	3000	1		30	51.000	2046 59 4
S25W FT	25	3000	1.2		30	70.000	2046 59 5
S32W FT	32	3000	1.2		21	98.000	2046 59 6
S40W FT	40	3000	1.2		15	124.000	2046 59 7
S50W FT	50	3000	1.2		15	156.000	2046 59 8
S63W FT	63	3000	1.2		9	198.000	2046 59 9

St Steel **FT** Hot-dip galvanised

Electrical installation pipe without threaded ends according to EN 61386-1 for mechanical protection of cables. With burr-free inner wall. Corrosion protection class 4 (high).



4 | 4 | 5 | 7 | 1

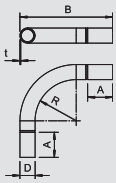

Hot-dip galvanised steel bend, without thread



Type	Dimension A mm	Dimension B mm	Dimension D mm	Dimension I mm	Dimension R mm	Dimension t mm		Pack.	Weight	Item No.
								pcs	kg/100 pcs.	
SBN16 FT	43.7	103	16.6	25	50	1		15	7.200	2046 81 6
SBN20 FT	53.7	155	20.6	30	90	1		25	13.300	2046 81 7
SBN25 FT	66.5	190	25.6	40	110	1.2		25	24.400	2046 81 8
SBN32 FT	86.5	254	32.7	40	150	1.2		20	41.000	2046 81 9
SBN40 FT	87.2	279	40.7	50	170	1.5		15	68.900	2046 82 0
SBN50 FT	131	358	51	60	200	1.5		5	111.800	2046 82 1
SBN63 FT	163	446	64	90	250	1.5		3	174.200	2046 82 2

St Steel **FT** Hot-dip galvanised

90° bend with moulded sleeves, for electrical installation pipes according to EN 61386-1. With burr-free inner wall.

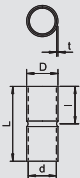

Hot-dip galvanised steel sleeve, without thread



Type	Dimension D mm	Dimension d mm	Dimension L mm	Dimension I mm	Dimension t mm		Pack.	Weight	Item No.
							pcs	kg/100 pcs.	
SV16W FT	18.6	18.6	50	25	1		25	2.200	2046 62 0
SV20W FT	23.1	20.7	60	30	1.2		50	3.200	2046 62 1
SV25W FT	28.1	25.7	60	30	1.2		50	5.600	2046 62 2
SV32W FT	35.2	32.8	70	35	1.2		50	7.100	2046 62 3
SV40W FT	43.8	40.8	80	40	1.5		25	12.500	2046 62 4
SV50W FT	54	51	100	50	1.5		10	19.400	2046 62 5
SV63W FT	67	63	100	50	1.5		5	24.300	2046 62 6

St Steel **FT** Hot-dip galvanised

Accessory part: plug-in sleeve for the connections between electrical installation pipes. With burr-free inner wall.



Aluminium pipes

Aluminium pipe, with thread



5 | 5 | 5 | 6 | 1

Type	Thread	Dimension D mm	Dimension L mm	Dimension l mm	Dimension t mm	Pack. m	Weight kg/100 m	Item No.
SM16W ALU	M16 x 1.5	16	3000	—	1.6	30	20.000	2046 03 2
SM20W ALU	M20 x 1.5	20	3000	—	1.9	30	30.000	2046 03 3
SM25W ALU	M25 x 1.5	25	3000	—	1.9	30	36.700	2046 03 4
SM32W ALU	M32 x 1.5	32	3000	—	1.9	30	50.000	2046 03 5
SM40W ALU	M40 x 1.5	40	3000	—	1.9	15	60.000	2046 03 6
SM50W ALU	M50 x 1.5	50	3000	—	2.1	15	86.700	2046 03 7
SM63W ALU	M63 x 1.5	63	3000	—	2.1	15	110.000	2046 03 8

Al Aluminium

Electrical installation pipe to EN 61386-1 with threaded ends to DIN EN 60423 for mechanical protection of cables.
With burr-free inner wall. One connection sleeve is already screwed onto each pipe.

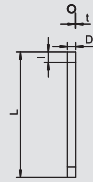

Aluminium pipe bend, with thread



Type	Thread	Dimension A mm	Dimension B mm	Dimension D mm	Dimension l mm	Dimension R mm	Dimension t mm	Pack. pcs	Weight kg/100 pcs.	Item No.
SBM16W ALU	M16 x 1.5	78	150	16	15	64	1.6	15	4.000	2046 04 2
SBM20W ALU	M20 x 1.5	80	170	20	15	80	1.9	25	7.000	2046 04 3
SBM25W ALU	M25 x 1.5	93	208	25	20	102.5	1.9	25	10.000	2046 04 4
SBM32W ALU	M32 x 1.5	105	252	32	20	131	1.9	20	15.000	2046 04 5
SBM40W ALU	M40 x 1.5	115	300	40	20	165	1.9	15	23.000	2046 04 6
SBM50W ALU	M50 x 1.5	128	358	50	25	205	2.1	5	37.000	2046 04 7
SBM63W ALU	M63 x 1.5	135	423	63	25	256.5	2.1	3	59.000	2046 04 8

Al Aluminium

90° bend for electrical installation pipes according to EN 61386-1 with threaded ends to DIN EN 60423. With burr-free inner wall. One connection sleeve is already screwed onto each pipe bend.

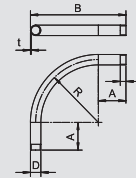

Aluminium sleeve, with thread



Type	Thread	Dimension D mm	Dimension d mm	Dimension L mm	Dimension t mm	Pack. pcs	Weight kg/100 pcs.	Item No.
SVM16W ALU	M16 x 1.5	18.5	16	35	2.25	50	0.800	2046 05 2
SVM20W ALU	M20 x 1.5	22.5	20	35	2.25	50	0.900	2046 05 3
SVM25W ALU	M25 x 1.5	28	25	45	2.5	50	1.800	2046 05 4
SVM32W ALU	M32 x 1.5	35	32	45	2.5	50	2.250	2046 05 5
SVM40W ALU	M40 x 1.5	43.5	40	45	2.75	20	3.100	2046 05 6
SVM50W ALU	M50 x 1.5	53.5	50	55	2.75	20	5.500	2046 05 7
SVM63W ALU	M63 x 1.5	66.5	63	55	2.8	20	6.200	2046 05 8

Al Aluminium

Accessory part: pipe connection sleeve with thread to DIN EN 60423 to connect electrical installation pipes and 90° bends.

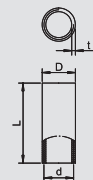



Aluminium pipe, without thread

Type	Dimension D mm	Dimension L mm	Dimension t mm		Pack.	Weight	Item No.
					m	kg/100 m	
S16W ALU	16	3000	1.2		30	15.067	2046 00 2
S20W ALU	20	3000	1.2		30	19.134	2046 00 3
S25W ALU	25	3000	1.3		30	26.134	2046 00 4
S32W ALU	32	3000	1.3		30	33.834	2046 00 5
S40W ALU	40	3000	1.4		15	45.800	2046 00 6
S50W ALU	50	3000	1.4		15	57.700	2046 00 7
S63W ALU	63	3000	1.7		15	88.334	2046 00 8

Al Aluminium

Electrical installation pipe without threaded ends to EN 61386-1 for mechanical protection of cables. With burr-free inner wall.



4 | 4 | 5 | 6 | 1

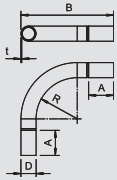

Aluminium bend, without thread

Type	Dimension A mm	Dimension B mm	Dimension D mm	Dimension l mm	Dimension R mm	Dimension t mm		Pack.	Weight	Item No.
								pcs	kg/100 pcs.	
SB16W ALU	78	151	16	28	64	1.2		15	4.000	2046 01 2
SB20W ALU	80	171	20	30	80	1.2		25	6.000	2046 01 3
SB25W ALU	93	209	25	38	102.5	1.3		25	9.000	2046 01 4
SB32W ALU	105	253	32	40	131	1.3		20	12.000	2046 01 5
SB40W ALU	115	302	40	50	165	1.4		15	20.000	2046 01 6
SB50W ALU	128	360	50	63	205	1.4		5	31.000	2046 01 7
SB63W ALU	135	425	63	70	256.5	1.7		3	45.000	2046 01 8

Al Aluminium

90° bend with moulded sleeves, for electrical installation pipes according to EN 61386-1. With burr-free inner wall.

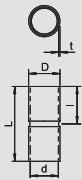

Aluminium sleeve, without thread

Type	Dimension M mm	Dimension L mm	Dimension D mm	Dimension t mm	Dimension d mm	Dimension l mm		Pack.	Weight	Item No.
								pcs	kg/100 pcs.	
SV16W ALU	16	40	18.6	1.2	—	—		50	1.000	2046 02 2
SV20W ALU	—	50	22.6	1.2	20.2	25		50	1.000	2046 02 3
SV25W ALU	—	60	27.6	1.2	25.2	30		50	2.000	2046 02 4
SV32W ALU	—	70	34.6	1.2	32.2	35		50	2.000	2046 02 5
SV40W ALU	—	70	43	1.4	40.2	35		20	3.000	2046 02 6
SV50W ALU	—	90	53	1.4	50.2	45		20	5.000	2046 02 7
SV63W ALU	—	110	66.2	1.5	63.2	55		20	9.000	2046 02 8

Al Aluminium

Accessory part: plug-in sleeve for the connections between electrical installation pipes. With burr-free inner wall.



Stainless steel pipes



5 | 5 | 5 | 7 | 1

Stainless steel pipe, V2A

Type	Dimension D mm	Dimension L mm	Dimension t mm	Pack. m	Weight kg/100 m	Item No.
S16W V2A	16	3000	1	30	37.000	2046 72 0
S20W V2A	20	3000	1	30	46.900	2046 72 1
S25W V2A	25	3000	1	30	59.200	2046 72 2
S32W V2A	32	3000	1.2	21	91.200	2046 72 3
S40W V2A	40	3000	1.2	15	114.800	2046 72 4
S50W V2A	50	3000	1.5	15	179.400	2046 72 5
S63W V2A	63	3000	1.5	9	227.500	2046 72 6

V2A Stainless steel, grade 304 Brushed

Electrical installation pipe without threaded ends according to EN 61386-1 for mechanical protection of cables. With burr-free inner wall. Corrosion protection class 4 (high). Classification according to EN 61386-1: 555711404010



Stainless steel bend, V2A



Type	Dimension A mm	Dimension B mm	Dimension D mm	Dimension I mm	Dimension R mm	Dimension t mm	Pack. pcs	Weight kg/100 pcs.	Item No.
SB16W V2A	54	104	18.2	25	50	1	15	7.250	2046 73 0
SB20W V2A	66	156	22.2	30	90	1	25	13.300	2046 73 1
SB25W V2A	81.5	194	27.2	30	112.5	1	25	20.400	2046 73 2
SB32W V2A	104	250	34.7	35	146	1.25	20	42.000	2046 73 3
SB40W V2A	129	294	42.7	40	165	1.25	15	61.200	2046 73 4
SB50W V2A	158	408	52.7	50	250	1.25	5	100.000	2046 73 5
SB63W V2A	198	448	65.7	50	250	1.25	3	120.000	2046 73 6

V2A Stainless steel, grade 304

90° bend with moulded sleeves, for electrical installation pipes according to EN 61386-1. With burr-free inner wall.

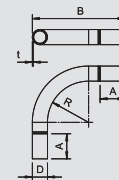

Stainless steel sleeve V2A



Type	Dimension D mm	Dimension d mm	Dimension L mm	Dimension I mm	Dimension t mm	Pack. pcs	Weight kg/100 pcs.	Item No.
SV16W V2A	18.2	16.2	50	25	1	25	2.100	2046 74 0
SV20W V2A	22.2	20.2	60	30	1	50	3.100	2046 74 1
SV25W V2A	27.2	25.2	60	30	1	50	3.900	2046 74 2
SV32W V2A	34.7	32.2	70	35	1.25	50	7.200	2046 74 3
SV40W V2A	42.7	40.2	80	40	1.25	25	10.300	2046 74 4
SV50W V2A	52.8	50.2	100	50	1.3	10	16.000	2046 74 5
SV63W V2A	65.8	63.2	100	50	1.3	5	20.100	2046 74 6

V2A Stainless steel, grade 304

Accessory part: plug-in sleeve for the connections between electrical installation pipes. With burr-free inner wall.

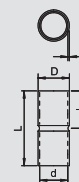

Stainless steel sleeve V2A, IP 67



Type	Size	Dimension A mm	Dimension L mm	Dimension D mm	Pack. pcs	Weight kg/100 pcs.	Item No.
SV20W V2A IP67	20	25	85	—	10	4.300	2046 48 8
SV25W V2A IP67	25	25	85	—	10	5.400	2046 49 0
SV32W V2A IP67	32	25	85	—	10	6.900	2046 49 2
SV40W V2A IP67	40	25	85	—	10	8.300	2046 49 4
SV50W V2A IP67	50	25	85	—	5	10.200	2046 49 6

V2A Stainless steel, grade 304

Accessory piece: Plug-in coupling with burr-free internal wall, thanks to internal O rings with IP67 dust-proof and waterproof. The riveted locking springs to both sides also ensure equipotential bonding. Classification according to EN 61386-1: 554511674010

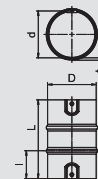



Stainless steel pipe, V4A

Type	Dimension D mm	Dimension L mm	Dimension t mm	Pack. m	Weight kg/100 m	Item No.
S16W V4A	16	3000	1	15	37.000	2046 75 0
S20W V4A	20	3000	1	15	46.900	2046 75 1
S25W V4A	25	3000	1	15	59.200	2046 75 2
S32W V4A	32	3000	1.2	15	91.200	2046 75 3
S40W V4A	40	3000	1.2	9	114.800	2046 75 4
S50W V4A	50	3000	1.5	9	179.400	2046 75 5
S63W V4A	63	3000	1.5	9	227.500	2046 75 6

V4A Stainless steel, grade 316 Ti Brushed

Electrical installation pipe without threaded ends according to EN 61386-1 for mechanical protection of cables. With burr-free inner wall. Corrosion protection class 4 (high).



5 | 5 | 5 | 7 | 1

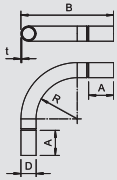

Stainless steel bend, V4A

Type	Dimension A mm	Dimension B mm	Dimension D mm	Dimension l mm	Dimension R mm	Dimension t mm	Pack. pcs	Weight kg/100 pcs.	Item No.
SB16W V4A	54	104	18.2	25	50	1	5	7.200	2046 76 0
SB20W V4A	66	156	22.2	30	90	1	10	13.300	2046 76 1
SB25W V4A	81.5	194	27.2	30	112.5	1	10	20.400	2046 76 2
SB32W V4A	104	250	34.7	35	146	1.25	10	42.000	2046 76 3
SB40W V4A	129	294	42.7	40	165	1.25	5	61.200	2046 76 4
SB50W V4A	158	408	52.7	50	250	1.25	5	79.500	2046 76 5
SB63W V4A	198	448	65.7	50	250	1.25	3	144.600	2046 76 6

V4A Stainless steel, grade 316 Ti

90° bend with moulded sleeves, for electrical installation pipes according to EN 61386-1. With burr-free inner wall.

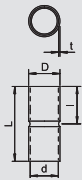

Stainless steel sleeve V4A

Type	Dimension D mm	Dimension d mm	Dimension L mm	Dimension l mm	Dimension t mm	Pack. pcs	Weight kg/100 pcs.	Item No.
SV16W V4A	18.2	16.2	50	25	1	10	2.100	2046 77 0
SV20W V4A	22.2	20.2	60	30	1	15	3.200	2046 77 1
SV25W V4A	27.2	25.2	60	30	1	15	3.900	2046 77 2
SV32W V4A	34.7	32.2	70	35	1.25	15	7.300	2046 77 3
SV40W V4A	42.7	40.2	80	40	1.25	10	10.300	2046 77 4
SV50W V4A	52.8	50.2	100	50	1.3	5	16.700	2046 77 5
SV63W V4A	65.8	63.2	100	50	1.3	3	20.900	2046 77 6

V4A Stainless steel, grade 316 Ti

Accessory part: plug-in sleeve for the connections between electrical installation pipes. With burr-free inner wall.



Metal pipes, system accessories



Pipe end cap, separable

Type	Size	Dimension D1	Dimension D2	Dimension L1	Dimension L2	Colour	Pack.	Weight	Item No.
		mm	mm	mm	mm		pcs	kg/100 pcs.	
129 TB M16	M16	20	10	30	3	Light grey	50	0.400	2047 81 2
129 TB M20	M20	24	13.4	30	3	Light grey	50	0.440	2047 83 1
129 TB M25	M25	30	18.4	30	3	Light grey	50	0.576	2047 83 9
129 TB M32	M32	36	25.4	30	3	Light grey	50	0.656	2047 85 5
129 TB M40	M40	44	33.4	30	3	Light grey	30	0.790	2047 86 3
129 TB M50	M50	53	43	30	3	Light grey	30	0.935	2047 89 0
129 TB M63	M63	67	56	30	3	Light grey	20	1.140	2047 89 8

PE Polyethylene

Separable pipe end cap to slot onto electrical installation pipes, metric.

The separable pipe end cap can be used for correct repair purposes on existing installations. It is not necessary to disconnect the cables, thus accelerating installation enormously.

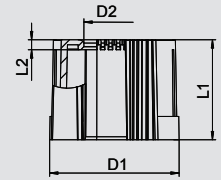

Pipe end cap, separable

Type	Size	Dimension D1	Dimension D2	Dimension L1	Dimension L2	Colour	Pack.	Weight	Item No.
		mm	mm	mm	mm		pcs	kg/100 pcs.	
129 TB M16 SW	M16	20	10	30	3	Black	50	0.400	2047 93 6
129 TB M20 SW	M20	24	13.4	30	3	Black	50	0.440	2047 94 4
129 TB M25 SW	M25	30	18.4	30	3	Black	50	0.576	2047 95 2
129 TB M32 SW	M32	36	25.4	30	3	Black	50	0.656	2047 97 1
129 TB M40 SW	M40	44	33.4	30	3	Black	30	0.790	2047 97 9
129 TB M50 SW	M50	53	43	30	3	Black	30	0.935	2047 98 7
129 TB M63 SW	M63	67	56	30	3	Black	20	1.140	2047 99 5

PE Polyethylene

Separable pipe end cap to slot onto electrical installation pipes, metric.

The separable pipe end cap can be used for correct repair purposes on existing installations. It is not necessary to disconnect the cables, thus accelerating installation enormously.

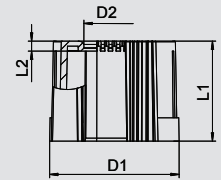

Pipe end cap, metric

Type	Size	Dimension D1	Dimension D2	Dimension L1	Dimension L2	Colour	Pack.	Weight	Item No.
		mm	mm	mm	mm		pcs	kg/100 pcs.	
129 M16	M16	19.4	12.5	18	2	Light grey	100	0.235	2047 81 0
129 M20	M20	23.4	16	22.5	2.5	Light grey	100	0.326	2047 82 9
129 M25	M25	28.4	21	27.5	2.5	Light grey	50	0.614	2047 83 7
129 M32	M32	35.4	27.5	34	3	Light grey	50	1.070	2047 85 3
129 M40	M40	43.4	35	41	3	Light grey	50	1.444	2047 86 1
129 M50	M50	53.4	44.5	48	3	Light grey	25	2.176	2047 88 8
129 M63	M63	66.4	55	59	4	Light grey	25	2.808	2047 89 6

PE Polyethylene

Pipe end cap to slot onto electrical installation pipes, metric.

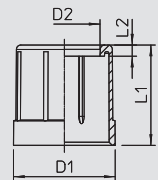

Pipe end cap, metric

Type	Size	Dimension D1	Dimension D2	Dimension L1	Dimension L2	Colour	Pack.	Weight	Item No.
		mm	mm	mm	mm		pcs	kg/100 pcs.	
129 M16 SW	M16	19.4	12.5	18	2	Black	100	0.235	2047 93 4
129 M20 SW	M20	23.4	16	22.5	2.5	Black	100	0.326	2047 94 2
129 M25 SW	M25	28.4	21	27.5	2.5	Black	50	0.614	2047 95 0
129 M32 SW	M32	35.4	27.5	34	3	Black	50	1.070	2047 96 9
129 M40 SW	M40	43.4	35	41	3	Black	50	1.444	2047 97 7
129 M50 SW	M50	53.4	44.5	48	3	Black	25	2.176	2047 98 5
129 M63 SW	M63	66.4	55	59	4	Black	25	2.808	2047 99 3

PE Polyethylene

Pipe end cap to slot onto electrical installation pipes, metric.

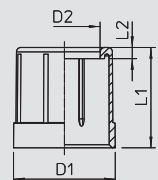

T piece with thread

Type	Size	Dimension D	Dimension L	Pack.	Weight	Item No.
		mm	mm	pcs	kg/100 pcs.	
SKTM16W ALU	16	47.5	72	15	7.200	2047 60 4
SKTM20W ALU	20	65	102	18	13.500	2047 60 5
SKTM25W ALU	25	75	115	10	22.000	2047 60 6
SKTM32W ALU	32	96	156	4	46.600	2047 60 7
SKTM40W ALU	40	96	156	4	34.000	2047 60 8
SKTM50W ALU	50	124.5	194	2	56.300	2047 60 9

AlG Cast aluminium

Die-cast aluminium T piece, with internal thread, for mounting in pipe sections as a junction. Removable cover for easier cable routing and later checking.

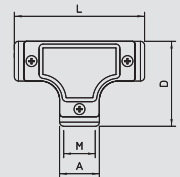

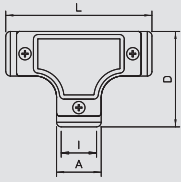

T piece without thread

Type	Size	Dimension D mm	Dimension L mm	Pack. pcs	Weight kg/100 pcs.	Item No.
SKT16W ALU	16	47.5	72	15	6.900	2047 58 8
SKT20W ALU	20	65	102	18	12.900	2047 58 9
SKT25W ALU	25	75	115	10	21.500	2047 59 0
SKT32W ALU	32	96	156	4	45.300	2047 59 1
SKT40W ALU	40	96	156	4	32.800	2047 59 2
SKT50W ALU	50	124.5	194	2	53.100	2047 59 3

AlG Cast aluminium

Die-cast aluminium T piece, for mounting in pipe sections as a junction.
Removable cover for easier cable routing and later checking.

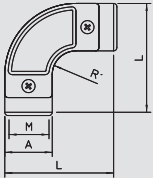

Control bend with thread

Type	Size	Dimension L mm	Pack. pcs	Weight kg/100 pcs.	Item No.
SKBM16W ALU	16	49.5	25	3.900	2047 63 8
SKBM20W ALU	20	65	25	9.300	2047 63 9
SKBM25W ALU	25	75	20	13.900	2047 64 0
SKBM32W ALU	32	96	8	29.700	2047 64 1
SKBM40W ALU	40	96	8	21.700	2047 64 2
SKBM50W ALU	50	124.5	4	34.800	2047 64 3

AlG Cast aluminium

90° die-cast aluminium control bend with internal thread for mounting in pipe sections with direction changes.
Removable cover for easier cable routing and later inspection.

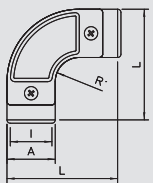

Control bend without thread

Type	Size	Dimension L mm	Pack. pcs	Weight kg/100 pcs.	Item No.
SKB16W ALU	16	49.5	25	3.600	2047 62 3
SKB20W ALU	20	65	25	9.000	2047 62 4
SKB25W ALU	25	75	20	13.400	2047 62 5
SKB32W ALU	32	96	8	27.700	2047 62 6
SKB40W ALU	40	96	8	20.900	2047 62 7
SKB50W ALU	50	124.5	4	34.300	2047 62 8

AlG Cast aluminium

90° die-cast aluminium control bend with internal thread for mounting in pipe sections with direction changes.
Removable cover for easier cable routing and later checking.

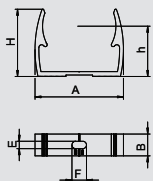

Quick clip, aluminium

Type	Nominal size	Pack. pcs	Weight kg/100 pcs.	Item No.
ALQ M16	16	100	0.780	2149 91 6
ALQ M20	20	100	0.900	2149 92 0
ALQ M25	25	100	1.111	2149 92 5
ALQ M32	32	50	1.600	2149 93 2
ALQ M40	40	50	2.400	2149 94 0
ALQ M50	50	25	2.730	2149 95 0
ALQ M63	63	20	3.340	2149 96 3

Al Aluminium

OBO Quick clip, type ALQ M, for all metric ALU pipe systems, as well as light-duty and heavy-duty insulation pipes. Suitable for mounting the OBO pipe system, material: aluminium. Pipe centring aids allow optimal attachment of the pipe and automatically turn the clip into the correct position. Slot for side alignment during mounting with wood screw or knock-in anchor. Recommended fastening spacing 50–60 cm.

Important dimensions, Quick clip ALU

G	A	B	E	F	H	h
	mm	mm	mm	mm	mm	mm
16	22	18	5.1	9.5	25	18.5
20	25	18	5.1	9.5	27.5	20
25	31	18	5.1	9.5	30	22
32	39	18	5.1	9.5	35	26
40	50	18	6.1	12	42	30.5
50	60	18	6.1	12	46.5	33.5
63	73	18	6.1	12	55.5	41.5



Metal pipes, system accessories



Cable and pipe spacer clip

Type	Clamping range D	Hole size	Material thickness	Size	Bolt	Pack.	Weight	Item No.
	mm	mm	mm			pcs	kg/100 pcs.	
732 16 GTP	14.5-16	M6	1	M16	M5 x 12	100	1.590	1360 16 7
732 20 GTP	18.5-20	M6	1	M20	M5 x 12	50	1.730	1360 20 5
732 26 GTP	24-26	M6	1	M25	M5 x 12	50	1.920	1360 26 4
732 33 GTP	31-33	M6	1.5	M32	M5 x 12	25	3.120	1360 33 7
732 40 GTP	38-40	M6	1.5	M40	M5 x 12	25	3.600	1360 39 6
732 42 GTP	40-42	M6	1.5	M40	M5 x 12	25	3.840	1360 42 6
732 50 GTP	48-50	M6	1.5	M50	M5 x 14	25	4.160	1360 50 7
732 63 GTP	61-63	M6	1.5	M63	M5 x 14	25	5.000	1360 63 9

St Steel

GTP Electrogalvanised, transparently passivated

With thread M6.

Important dimensions, cable and pipe spacer clip

D	A	B	x	b1	t1	t2	M
mm	mm	mm	mm	mm	mm	mm	
14.5-16	42	30	1.5	18	1	1.25	M5 x 12
18.5-20	46	34	1.5	18	1	1.25	M5 x 12
24-26	52	40	2	18	1	1.25	M5 x 12
31-33	64	50	2	18	1.5	1.5	M5 x 12
38-40	71	57	2	18	1.5	1.5	M5 x 12
40-42	73	59	2	18	1.5	1.5	M5 x 12
48-50	81	67	2	18	1.5	1.5	M5 x 14
61-63	94	80	2	18	1.5	1.5	M5 x 14

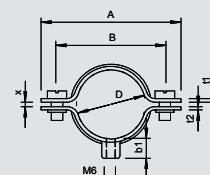

Cable and pipe spacer clip, V4A

Type	Clamping range D	Hole size	Material thickness	Size	Bolt	Pack.	Weight	Item No.
	mm	mm	mm			pcs	kg/100 pcs.	
732 16 V4A	14.5-16	M6	1	M16	M5 x 12	100	1.845	1360 65 6
732 20 V4A	18.5-20	M6	1	M20	M5 x 12	50	1.960	1360 66 0
732 26 V4A	24-26	M6	1	M25	M5 x 12	50	2.083	1360 66 6
732 33 V4A	31-33	M6	1.5	M32	M5 x 12	25	3.186	1360 67 2
732 40 V4A	38-40	M6	1.5	M40	M5 x 12	25	3.554	1360 67 8
732 42 V4A	40-42	M6	1.5	M40	M5 x 12	25	3.650	1360 68 0
732 50 V4A	48-50	M6	1.5	M50	M5 x 14	25	4.045	1360 68 6
732 63 V4A	61-63	M6	1.5	M63	M5 x 14	25	4.712	1360 69 0

V4A Stainless steel, grade 316 Ti

With thread M6.

D	A	B	x	b1	t1	t2	M
mm	mm	mm	mm	mm	mm	mm	
14.5-16	42	30	1.5	18	1	1.25	M5 x 12
18.5-20	46	34	1.5	18	1	1.25	M5 x 12
24-26	52	40	2	18	1	1.25	M5 x 12
31-33	64	50	2	18	1.5	1.5	M5 x 12
38-40	71	57	2	18	1.5	1.5	M5 x 12
40-42	73	59	2	18	1.5	1.5	M5 x 12
48-50	81	67	2	18	1.5	1.5	M5 x 14
61-63	94	80	2	18	1.5	1.5	M5 x 14

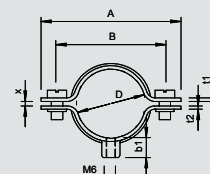

Cable and pipe spacer clip

Type	Clamping range D	Hole size	Material thickness	Size	Bolt	Pack.	Weight	Item No.
	mm	mm	mm			pcs	kg/100 pcs.	
733 16 G	14-16	6.5 x 10	1.5	M16	M5 x 14	50	2.430	1361 16 3
733 21 G	19-21	6.5 x 10	1.5	M20	M5 x 14	50	2.730	1361 20 1
733 29 G	24-29	6.5 x 10	1.5	M25	M5 x 18	50	3.480	1361 29 5
733 38 G	30-38	6.5 x 10	1.5	M32	M5 x 18	25	4.040	1361 38 4
733 48 G	39-48	6.5 x 10	1.5	M40	M5 x 18	25	4.810	1361 48 1
733 54 G	48-54	6.5 x 14	1.5	M50	M5 x 18	25	5.800	1361 51 1
733 63 G	63	6.5 x 14	1.5	M63	M5 x 18	20	6.940	1361 63 5

St Steel

G Electrogalvanised

Steel bolt material.

* Size M16 not suitable for nail device.

* Sizes M16 to PG16 not suitable for bolt-firing tool.

Important dimensions, cable and pipe spacer clip

D	A	B	L	b	x
mm	mm	mm	mm	mm	mm
14-16	43	30	10	14	3
19-21	50	37	10	14	2
24-29	58	42	10	16	7
30-38	70	54	10	16	10
39-48	80	64	14	16	12.5
48-54	86	68	14	18	7.5
63	101	83	18	16	3

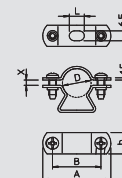

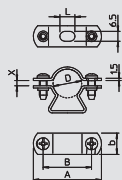

Cable and pipe spacer clip

Type	Clamping range D	Hole size	Material thickness	Size	Bolt	Pack.	Weight	Item No.
	mm	mm	mm			pcs	kg/100 pcs.	
733 16 FT	14-16	6.5 x 10	1.5	M 16	M5 x 14	50	2.430	1361 09 4
733 21 FT	19-21	6.5 x 10	1.5	M 20	M5 x 14	50	2.730	1361 10 0
733 29 FT	24-29	6.5 x 10	1.5	M 25	M5 x 18	50	3.480	1361 10 6
733 38 FT	30-38	6.5 x 10	1.5	M 32	M5 x 18	25	4.040	1361 10 9
733 48 FT	39-48	6.5 x 10	1.5	M 40	M5 x 18	25	4.810	1361 11 2
733 54 FT	48-54	6.5 x 14	1.5	M 50	M5 x 18	25	5.400	1361 11 7
733 63 FT	63	8 x 18	2	M 63	M5 x 18	20	7.250	1361 11 8



St Steel **FT** Hot-dip galvanised

Steel bolt material.

* Size M16 is not suitable for nail device.

* Sizes M16 - PG16 not suitable for bolt-firing tool.

Important dimensions, cable and pipe spacer clip

D	A	B	L	b	x
mm	mm	mm	mm	mm	mm
14 - 16	43	30	10	14	3
19 - 21	50	37	10	14	2
24 - 29	58	42	10	16	7
30 - 38	70	54	10	16	10
39 - 48	80	64	14	16	12.5
48-54	86	68	14	18	7.5
63	101	83	18	16	3

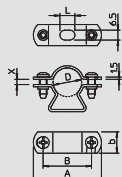

Cable and pipe spacer clip, aluminium

Type	Clamping range D	Hole size	Material thickness	Size	Bolt	Pack.	Weight	Item No.
	mm	mm	mm			pcs	kg/100 pcs.	
733 16 ALU	14-16	6.5 x 10	1.5	M16	M5 x 12	50	0.980	1362 52 6
733 21 ALU	19-21	6.5 x 10	1.5	M20	M5 x 16	50	1.100	1362 54 2
733 29 ALU	24-29	6.5 x 10	1.5	M25	M5 x 16	50	1.390	1362 56 9
733 38 ALU	30-38	6.5 x 10	1.5	M32	M5 x 18	25	1.620	1362 57 7
733 48 ALU	39-48	6.5 x 10	1.5	M40	M5 x 18	25	1.950	1362 58 5
733 54 ALU	48-54	6.5 x 14	1.5	M50	M5 x 18	25	2.320	1362 59 3
733 63 ALU	63	8 x 18	2	M63	M5 x 18	20	2.990	1362 61 5



Al Aluminium

Bolt material: VA

* Size M16 not suitable for nail device.

* Sizes M16 to PG16 not suitable for bolt-firing tool.

Important dimensions, cable and pipe spacer clip

D	A	B	L	b	x
mm	mm	mm	mm	mm	mm
14-16	43	30	10	14	3
19-21	50	37	10	14	2
24-29	58	42	10	16	7
30-38	70	54	10	16	10
39-48	80	64	14	16	12.5
48-54	86	68	14	18	7.5
63	101	83	18	16	3

Metal pipes, system accessories



Cable and pipe spacer clip, V2A

Type	Clamping range D	Hole size	Material thickness	Size	Bolt	Pack.	Weight	Item No.
	mm	mm	mm			pcs	kg/100 pcs.	
733 16 VA	14-16	6.5 x 10	1.5	M16	M5 x 12	50	2.430	1362 01 1
733 21 VA	19-21	6.5 x 10	1.5	M20	M5 x 16	50	2.740	1362 04 6
733 29 VA	24-29	6.5 x 10	1.5	M25	M5 x 16	50	3.475	1362 06 2
733 38 VA	30-38	6.5 x 10	1.5	M32	M5 x 18	25	4.500	1362 07 0
733 48 VA	39-48	6.5 x 10	1.5	M40	M5 x 18	25	5.200	1362 08 9
733 54 VA	48-54	6.5 x 14	1.5	M50	M5 x 18	25	5.800	1362 09 7
733 63 VA	63	8 x 18	2	M63	M5 x 18	20	6.940	1362 12 7

V2A Stainless steel, grade 304

Bolt material: VA

* Size M16 not suitable for nail device.

* Sizes M16 to PG16 not suitable for bolt-firing tool.

Important dimensions, cable and pipe spacer clip

D	A	B	L	b	x
mm	mm	mm	mm	mm	mm
14-16	43	30	10	14	3
19-21	50	37	10	14	2
24-29	58	42	10	16	7
30-38	70	54	10	16	10
39-48	80	64	14	16	12.5
48-54	86	68	14	18	7.5
63	101	83	18	16	3

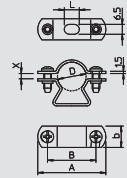

Cable and pipe spacer clip, V4A

Type	Clamping range D	Hole size	Material thickness	Size	Bolt	Pack.	Weight	Item No.
	mm	mm	mm			pcs	kg/100 pcs.	
733 16 V4A	14-16	6.5 x 10	1.5	M 16	M5 x 14	50	2.430	1361 64 7
733 21 V4A	19-21	6.5 x 10	1.5	M 20	M5 x 14	50	2.730	1361 65 5
733 29 V4A	24-29	6.5 x 10	1.5	M 25	M5 x 18	50	3.420	1361 66 3
733 38 V4A	30-38	6.5 x 10	1.5	M 32	M5 x 18	25	4.040	1361 66 7
733 48 V4A	39-48	6.5 x 10	1.5	M 40	M5 x 18	25	4.810	1361 67 1
733 54 V4A	48-54	6.5 x 14	1.5	M 50	M5 x 18	25	5.800	1361 67 5
733 63 V4A	63	8.2 x 18	2	M 63	M5 x 18	20	6.940	1361 68 3

V4A Stainless steel, grade 316 Ti

Bolt material: VA

* Size M16 not suitable for nail device.

* Sizes M16 to PG16 not suitable for bolt-firing tool.

Important dimensions, cable and pipe spacer clip

D	A	B	L	b	x
mm	mm	mm	mm	mm	mm
14 - 16	43	30	10	14	3
19 - 21	50	37	10	14	2
24 - 29	58	42	10	16	7
30 - 38	70	54	10	16	10
39 - 48	80	64	14	16	12.5
48-54	86	68	14	18	7.5
63	101	83	18	16	3

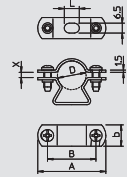

Fastening clip, heavy-duty, V4A

Type	For Ø	Size	Shipping box	Pack.	Weight	Item No.
	mm		pcs	pcs	kg/100 pcs.	
822 16 V4A	15.2	M16	400	100	1.733	1013 87 7
822 20 V4A	20	M20	600	100	2.125	1013 88 5
822 25 V4A	25	M25	500	50	2.400	1013 89 3
822 32 V4A	32	M32	100	100	5.490	1013 90 3
822 40 V4A	40	M40	100	100	6.590	1013 91 1
822 50 V4A	50	M50	100	100	7.690	1013 92 1
822 63 V4A	63	M63	100	100	9.260	1013 92 5

V4A Stainless steel, grade 316 Ti

Single-lobe fastening clip for cables and pipes.

Important dimensions, fastening clip

D	L	L1	H	b	t	A
mm	mm	mm	mm	mm	mm	mm
15.2	23.5	42	14	20	2	10
20	23.5	48	19.5	20	2	10
25	25.5	53	23.5	20	2	11
32	32.5	68	30	25	3	13
40	32.5	76	38	25	3	13
50	32.5	86	47	25	3	15
63	33.5	100	60	25	3	15

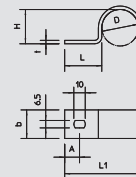

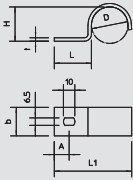

Fastening clip, heavy-duty

Type	For Ø	Size	Pack.	Weight	Item No.
	mm		pcs	kg/100 pcs.	
822 16 FT	15.2	M16	100	1.733	1014 09 9
822 20 FT	20	M20	100	2.125	1014 13 7
822 25 FT	25	M25	50	2.400	1014 50 1
822 32 FT	32	M32	100	5.490	1014 52 8
822 40 FT	40	M40	100	6.590	1014 53 6
822 50 FT	50	M50	100	7.690	1014 54 4
822 63 FT	63	M63	100	9.260	1014 55 2



St Steel **FT** Hot-dip galvanised

Single-lobe fastening clip for cables and pipes.

Important dimensions, fastening clip

D	L	L1	H	b	t	A
mm	mm	mm	mm	mm	mm	mm
15.2	23.5	42	14	20	2	10
20	23.5	48	19.5	20	2	10
25	25.5	53	23.5	20	2	11
32	32.5	68	30	25	3	13
40	32.5	76	38	25	3	13
50	32.5	86	47	25	3	15
63	33.5	100	60	25	3	15

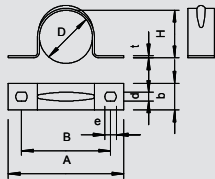

Fastening clip, medium-duty

Type	For Ø	Hole size	Material thickness	Shipping box	Pack.	Weight	Item No.
	mm	mm	mm	pcs	pcs	kg/100 pcs.	
605 16 G	16	4.5 x 6	1	1200	100	0.585	1018 16 7
605 20 G	20	4.5 x 6	1	1000	100	0.664	1018 20 5
605 25 G	25	4.5 x 6	1	1200	100	0.960	1018 25 6
605 32 G	32	4.5 x 6	1	1200	100	1.260	1018 33 7
605 40 G	40	5.5 x 7	1.5	600	50	1.900	1018 39 6
605 50 G	50	5.5 x 7	1.5	300	25	2.770	1018 50 7
605 63 G	63	5.5 x 7	1.5	300	25	3.670	1018 63 9



St Steel **G** Electrogalvanised

Two lobe fastening clips for cables and pipes.

* Sizes 7 to 12 not suitable for bolt-firing tool.

Important dimensions, fastening clip

D	A	B	H	b	t	d	e
mm	mm	mm	mm	mm	mm	mm	mm
16	44	32	14.5	12	1	4.5	6
20	49	37	18.5	12	1	4.5	6
25	58	44	23	14	1	4.5	6
33	66	52	30	14	1	4.5	6
40	75	61	37	14	1.5	5.5	7
50	88	74	46	16	1.5	5.5	7
63	112	98	59	16	1.5	5.5	7

Fastening clip, medium-duty

Type	For Ø	Hole size	Material thickness	Shipping box	Pack.	Weight	Item No.
	mm	mm	mm	pcs	pcs	kg/100 pcs.	
605 16 ALU	16	4.5 x 6	1	2000	100	0.218	1017 79 9
605 20 ALU	20	4.5 x 6	1	1200	100	0.228	1017 83 7
605 25 ALU	25	4.5 x 6	1	1000	100	0.330	1017 86 1
605 32 ALU	32	4.5 x 6	1	1200	100	0.433	1017 92 6
605 40 ALU	40	5.5 x 7	1	600	50	0.650	1017 95 0
605 50 ALU	50	5.5 x 7	1.5	300	25	0.952	1017 98 0
605 63 ALU	63	5.5 x 7	1.5	300	25	1.260	1017 99 7



Al Aluminium

Two lobe fastening clips for cables and pipes.

Important dimensions, fastening clip

D	A	B	H	b	t	d	e
mm	mm	mm	mm	mm	mm	mm	mm
16	44	32	14.5	12	1	4.5	6
20	49	37	18.5	12	1	4.5	6
25	58	44	23	14	1	4.5	6
32	95	71	29	25	1	4.5	6
40	75	61	37	14	1.5	5.5	7
50	110	86	46	25	1.5	5.5	7
63	120	96	59	25	1.5	5.5	7

Metal pipes, system accessories

Fastening clip, medium-duty, V4A



Type	For Ø	Hole size	Material thickness	Shipping box	Pack.	Weight	Item No.
	mm	mm	mm	pcs	pcs	kg/100 pcs.	
605 16 V4A	16	4.5 x 6	1	1200	100	0.585	1018 66 1
605 20 V4A	20	4.5 x 6	1	1000	100	0.664	1018 66 9
605 25 V4A	25	4.5 x 6	1	1200	100	0.992	1018 67 9
605 32 V4A	32	4.5 x 6	1	1200	100	1.260	1018 69 3
605 40 V4A	40	5.5 x 7	1.5	600	50	1.900	1018 70 5
605 50 V4A	50	5.5 x 7	1.5	300	25	2.770	1018 71 7
605 63 V4A	63	5.5 x 7	1.5	300	25	3.670	1018 72 9

V4A Stainless steel, grade 316 Ti

Two lobe fastening clips for cables and pipes.

Important dimensions, fastening clip

D	A	B	H	b	t	d	e
mm	mm	mm	mm	mm	mm	mm	mm
16	44	32	14.5	12	1	4.5	6
20	49	37	18.5	12	1	4.5	6
25	58	44	23	14	1	4.5	6
32	66	52	30	14	1	4.5	6
40	75	61	37	14	1.5	5.5	7
50	88	74	46	16	1.5	5.5	7
63	112	98	59	16	1.5	5.5	7

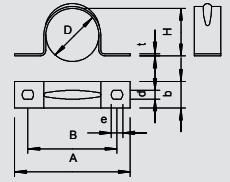

Fastening clip, heavy-duty

Type	For Ø	Hole size	Material thickness	Shipping box	Pack.	Weight	Item No.
	mm	mm	mm	pcs	pcs	kg/100 pcs.	
823 16 FT	16	6.5 x 10	2	500	50	2.260	1015 09 5
823 20 FT	20	6.5 x 10	2	500	50	2.662	1015 13 3
823 25 FT	25	6.5 x 10	3	250	25	6.770	1015 49 4
823 32 FT	32	6.5 x 10	3	100	100	7.469	1015 49 6
823 40 FT	40	6.5 x 10	3	100	100	8.460	1015 49 8
823 50 FT	50	6.5 x 10	3	100	100	9.050	1015 50 0
823 63 FT	63	6.5 x 10	3	100	100	10.700	1015 50 8

St Steel

FT Hot-dip galvanised

Two lobe fastening clips for cables and pipes.

Important dimensions, fastening clip

D	A	B	H	b	t	e
mm	mm	mm	mm	mm	mm	mm
15.2	59	40	13	20	2	10
20.4	64	45	18	20	2	10
25	79	60	23.5	25	3	10
32	95	71	29	25	3	10
40	100	76	36	25	3	10
50	110	86	46	25	3	10
63	120	96	59	25	3	10

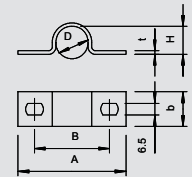

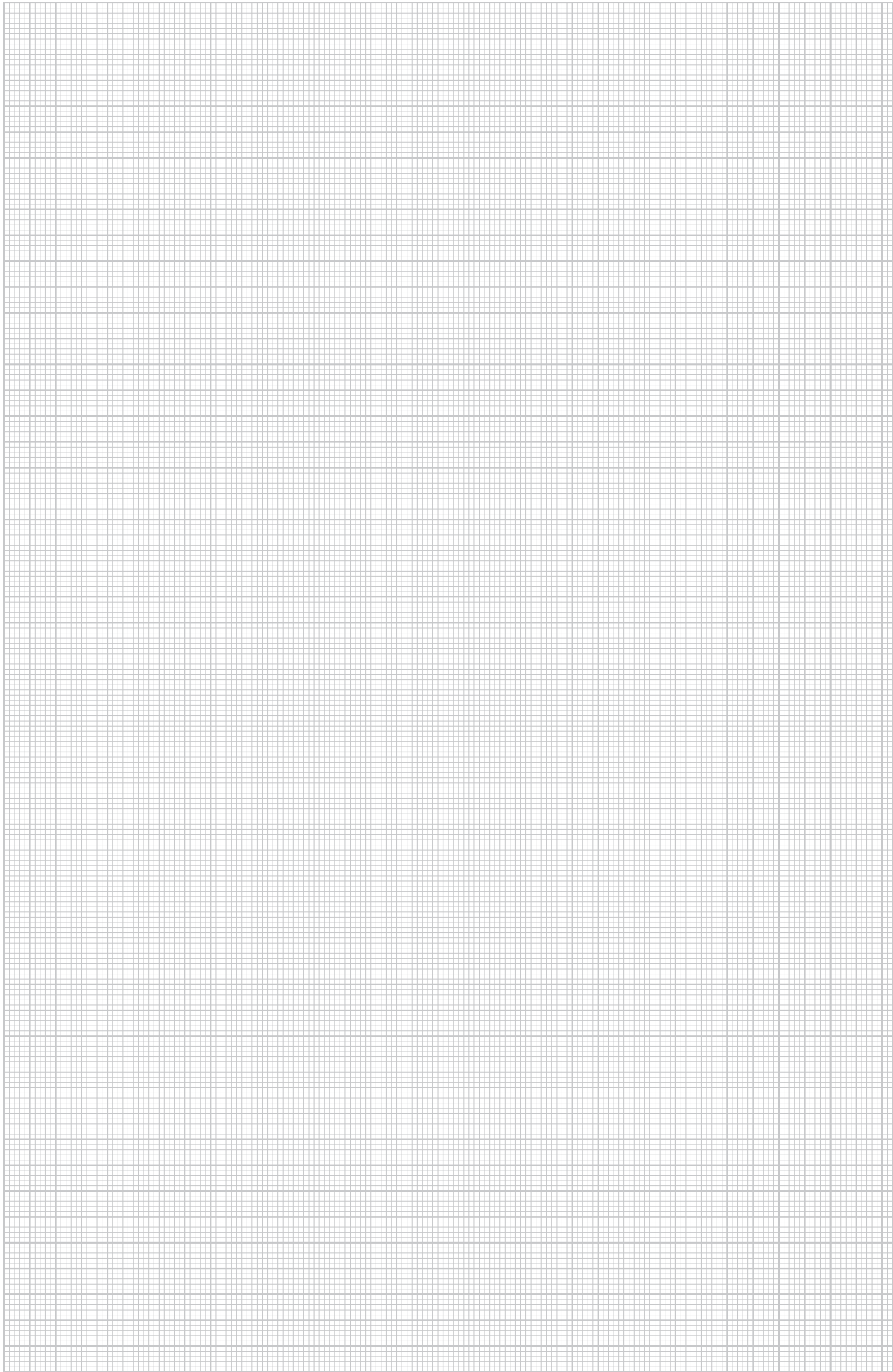

Junction box, T series with plug-in seal and terminal strip, light grey



- Neat and clean wiring thanks to pre-mounted terminal strips
- If the cable cross-section is large, the connection terminals are arranged at the top edge. The installation will therefore become significantly easier
- High impermeability of IP66. Plug-in seals made from ethylene vinyl acetate (EVA). Alternatively, cable glands or pipe entries can be mounted.
- High impact resistance due to robust construction and high-quality materials
- Universally deployable: UV-resistant for use outdoors, halogen-free for the use indoors



T 25, plug-in seal and terminal strip

Type	Version	Entries	Colour	Pack.	Weight	Item No.
				pcs	kg/100 pcs.	
T 25 KL	With terminal strip	4 x M25	Light grey	5	6.400	2007 43 0

PP Polypropylene

The junction boxes are made of a thermoplastic polypropylene polymer with plug-in seals made of ethylene vinyl acetate (EVA). This plastic is soft, which means that it is malleable. This allows installation of cables either directly through the 4 x M25 seals, or the seals can be cut with a knife at the pre-marked points, in order to create an insertion opening for cables or pipes. In addition, cable glands can be inserted through the openings instead of the seals and locked with a locknut from inside.

The cable junction boxes can be screwed onto an M6 thread or mounted on mounting plates in the openings on the floor using steel bolts 3.5 x 9.5.

Clear internal dimensions: Ø63 x 45 mm.

Cover with labelling panel.

Standard version: flame-resistant, testing temperature 650 °C.

F version: highly flame-resistant, testing temperature 960 °C.

Clear internal dimensions: Ø63 x 45 mm

Protection rating IP65; Protection rating IK code IK08.

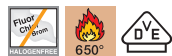
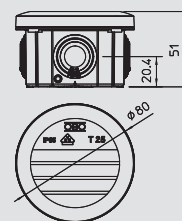

T 40, plug-in seal and terminal strip

Type	Version	Entries	Colour	Pack.	Weight	Item No.
				pcs	kg/100 pcs.	
T 40 KL	With terminal strip	7 x M25	Light grey	5	8.900	2007 43 2

PP Polypropylene

All the T series junction boxes are UV-resistant. The cable junction boxes are made of a thermoplastic polypropylene plastic with plug-in seals made of ethylene vinyl acetate (EVA). This plastic is soft, which means that it is malleable. This allows installation of cables through the 7 x M25 seals, or the seals can be cut with a knife at the pre-marked points, in order to create an insertion opening for cables or pipes. Alternatively, instead of seals, cable glands can be inserted through the openings and be countered internally with a locknut.

The junction boxes can be mounted on mounting plates in the openings on the floor using steel bolts 3.5 x 9.5.

Clear internal dimensions: 77 x 77 x 46 mm

Cover with labelling panel and lead-sealed.

Standard version: flame-resistant, testing temperature 650 °C.

F version: highly flame-resistant, testing temperature 960 °C.

Clear internal dimensions: 77 x 77 x 46 mm

Protection rating IP55; Protection rating IK code IK07.

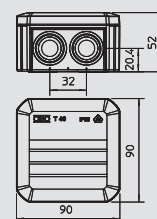

Junction box, T series with plug-in seal and terminal strip, light grey

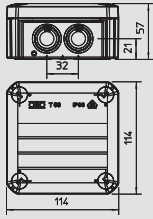

T 60, plug-in seal and terminal strip



Type	Version	Entries	Colour	Pack.	Weight	Item No.
				pcs	kg/100 pcs.	
T 60 KL	With terminal strip	7 x M25	Light grey	5	16.700	2007 43 4

PP Polypropylene

All the T series junction boxes are UV-resistant. The cable junction boxes are made of a thermoplastic polypropylene plastic with plug-in seals made of ethylene vinyl acetate (EVA). This plastic is soft, which means that it is malleable. This allows installation of cables through the 7 x M25 seals, or the seals can be cut with a knife at the pre-marked points, in order to create an insertion opening for cables or pipes. Alternatively, instead of seals, cable glands can be inserted through the openings and be countered internally with a locknut.

The junction boxes can be mounted on mounting plates in the openings on the floor using steel bolts 3.5 x 9.5.

Clear internal dimensions: 100 x 100 x 48 mm

Cover with labelling panel and lead-sealed.

Standard version: flame-resistant, testing temperature 650 °C.

F version: highly flame-resistant, testing temperature 960 °C.

Clear internal dimensions: 100 x 100 x 48 mm

Protection rating IP66; Protection rating IK code IK08.

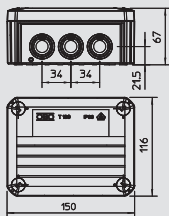

T 100, plug-in seal and terminal strip



Type	Version	Entries	Colour	Pack.	Weight	Item No.
				pcs	kg/100 pcs.	
T 100 KL	With terminal strip	10 x M25	Light grey	1	40.000	2007 43 6

PP Polypropylene

All the T series junction boxes are UV-resistant. The cable junction boxes are made of a thermoplastic polypropylene plastic with plug-in seals made of ethylene vinyl acetate (EVA). This plastic is soft, which means that it is malleable. This allows installation of cables through the 10 x M25 seals, or the seals can be cut with a knife at the pre-marked points, in order to create an insertion opening for cables or pipes. Alternatively, instead of seals, cable glands can be inserted through the openings and be countered internally with a locknut.

The junction boxes can be mounted on mounting plates in the openings on the floor using steel bolts 3.5 x 9.5.

Clear internal dimensions: 136 x 102 x 57 mm

Cover with labelling panel and lead-sealed.

Standard version: flame-resistant, testing temperature 650 °C.

F version: highly flame-resistant, testing temperature 960 °C.

Clear internal dimensions: 136 x 102 x 57 mm

Protection rating IP66; Protection rating IK code IK08.

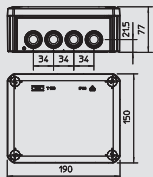

T 160, plug-in seal and terminal strip

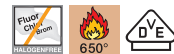

Type	Version	Entries	Colour	Pack.	Weight	Item No.
				pcs	kg/100 pcs.	
T 160 KL	With terminal strip	7 x M25 5 x M32	Light grey	1	64.200	2007 44 0

PP/GF Polypropylene, Glass-fibre reinforced

All the T series junction boxes are UV-resistant. The cable junction boxes are made of a thermoplastic polypropylene plastic with plug-in seals made of ethylene vinyl acetate (EVA). This plastic is soft, which means that it is malleable. This allows installation of cables through the 7x M25 + 5x M32 seals, or the seals can be cut with a knife at the pre-marked points, in order to create an insertion opening for cables or pipes. Alternatively, instead of seals, cable glands can be inserted through the openings and be countered internally with a locknut.

The junction boxes can be mounted on mounting plates in the openings on the floor using steel bolts 3.5 x 9.5.

Clear internal dimensions: 176 x 135 x 67 mm

Cover with labelling panel and lead-sealed.

Standard version: flame-resistant, testing temperature 650 °C.

F version: highly flame-resistant, testing temperature 960 °C.

Clear internal dimensions: 176 x 135 x 67 mm

Protection rating IP66; Protection rating IK code IK06.



Junction box, T series with plug-in seal and terminal strip, light grey



T 250, plug-in seal and terminal strip

Type	Version	Entries	Colour	Pack.	Weight	Item No.
T 250 KL	With terminal strip	9 x M25 7 x M32	Light grey	1 pcs	79.500 kg/100 pcs.	2007 44 4

PP/GF Polypropylene, Glass-fibre reinforced

All the T series junction boxes are UV-resistant. The cable junction boxes are made of a thermoplastic polypropylene plastic with plug-in seals made of ethylene vinyl acetate (EVA). This plastic is soft, which means that it is malleable. This allows installation of cables through the 9x M25 + 7x M32 seals, or the seals can be cut with a knife at the pre-marked points, in order to create an insertion opening for cables or pipes. Alternatively, instead of seals, cable glands can be inserted through the openings and be countered internally with a locknut.

The junction boxes can be mounted on mounting plates in the openings on the floor using steel bolts 3.5 x 9.5.

Clear internal dimensions: 225 x 173 x 86 mm

Cover with labelling panel and lead-sealed.

Standard version: flame-resistant, testing temperature 650 °C.

F version: highly flame-resistant, testing temperature 960 °C.

Clear internal dimensions: 225 x 173 x 86 mm

Protection rating IP66; Protection rating IK code IK06.

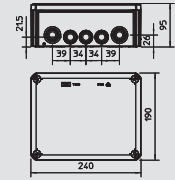

T 350, plug-in seal and terminal strip

Type	Version	Entries	Colour	Pack.	Weight	Item No.
T 350 KL	With terminal strip	16 x M32 8 x M40	Light grey	1 pcs	120.000 kg/100 pcs.	2007 44 8

PP/GF Polypropylene, Glass-fibre reinforced

All the T series junction boxes are UV-resistant. The cable junction boxes are made of a thermoplastic polypropylene plastic with plug-in seals made of ethylene vinyl acetate (EVA). This plastic is soft, which means that it is malleable. This allows installation of cables through the 16x M32 + 8x M40 seals, or the seals can be cut with a knife at the pre-marked points, in order to create an insertion opening for cables or pipes. Alternatively, instead of seals, cable glands can be inserted through the openings and be countered internally with a locknut.

The junction boxes can be mounted on mounting plates in the openings on the floor using steel bolts 3.5 x 9.5.

Clear internal dimensions: 267 x 182 x 110 mm

Cover with labelling panel and lead-sealed.

Standard version: flame-resistant, testing temperature 650 °C.

F version: highly flame-resistant, testing temperature 960 °C.

Clear internal dimensions: 267 x 182 x 110 mm

Protection rating IP66; Protection rating IK code IK06.

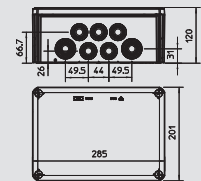

Junction box, aluminium

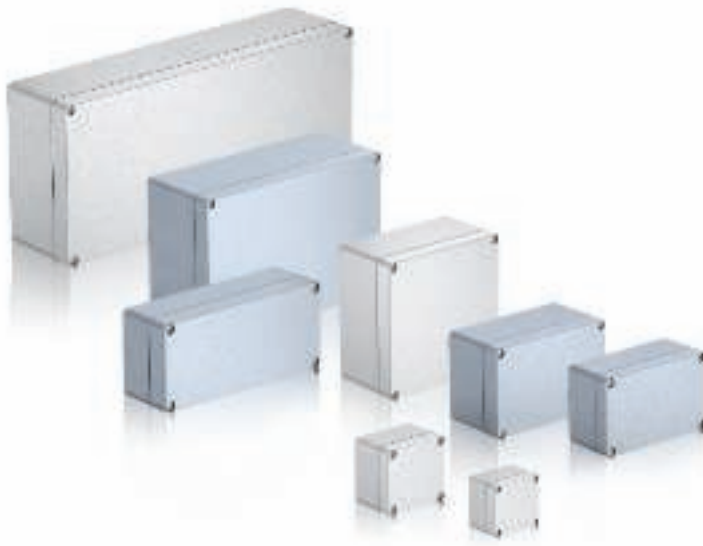

- Robust aluminium empty housing for mechanical engineering and automation technology
- Suitable for extreme strains in all different areas
- Application in industry, ports and shipbuilding as well as in the agricultural sector
- With a protection class of up to IP66, they are optimally protected against the intrusion of water
- Aluminium is UV-resistant and halogen-free. The cover seal is made from polyurethane.

**IP
66**

Aluminium empty housing Mx06 powder coated

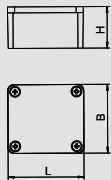

Type	Length mm	Width mm	Height mm	Colour	Pack. pcs	Weight kg/100 pcs.	Item No.
Mx 060503 SGR	64	58	36	Silver grey	1	13.500	2011 30 4

AIG Cast aluminium **P** Powder-coated

Robust aluminium empty housing for mechanical engineering and automation technology. The OBO Mx series' excellent mechanical and thermal features make it most suitable for extreme demands in many different areas. It is therefore also best suited for applications in industry, ports and shipbuilding, as well as in the agricultural sector. The products protect the electrical installation against high-grade strains. They withstand both extreme cold and heat as well as vandalism and impact on roads, railways or in tunnels. With an IP66 protection class, they are optimally protected against the intrusion of dust and water. The aluminium housings are plastic coated (RAL 7035) and are delivered with a cover including stainless steel screws, a seal and two or four earthing screws.
Temperature: -40°C to +125°C



Aluminium empty housing Mx08 powder coated

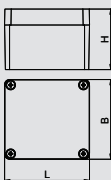

Type	Length mm	Width mm	Height mm	Colour	Pack. pcs	Weight kg/100 pcs.	Item No.
Mx 080705 SGR	80	75	57	Silver grey	1	30.600	2011 30 8

AIG Cast aluminium **P** Powder-coated

Robust aluminium empty housing for mechanical engineering and automation technology. The OBO Mx series' excellent mechanical and thermal features make it most suitable for extreme demands in many different areas. It is therefore also best suited for applications in industry, ports and shipbuilding, as well as in the agricultural sector. The products protect the electrical installation against high-grade strains. They withstand both extreme cold and heat as well as vandalism and impact on roads, railways or in tunnels. With an IP66 protection class, they are optimally protected against the intrusion of dust and water. The aluminium housings are plastic coated (RAL 7035) and are delivered with a cover including stainless steel screws, a seal and two or four earthing screws.
Temperature: -40°C to +125°C



Junction box, aluminium



Aluminium empty housing Mx12 powder coated

Type	Length	Width	Height	Colour	Pack.	Weight	Item No.
	mm	mm	mm		pcs	kg/100 pcs.	
Mx 120805 SGR	125	80	57	Silver grey	1	30.600	2011 31 2

AIG Cast aluminium **P** Powder-coated

Robust aluminium empty housing for mechanical engineering and automation technology. The OBO Mx series' excellent mechanical and thermal features make it most suitable for extreme demands in many different areas. It is therefore also best suited for applications in industry, ports and shipbuilding, as well as in the agricultural sector. The products protect the electrical installation against high-grade strains. They withstand both extreme cold and heat as well as vandalism and impact on roads, railways or in tunnels. With an IP66 protection class, they are optimally protected against the intrusion of dust and water. The aluminium housings are plastic coated (RAL 7035) and are delivered with a cover including stainless steel screws, a seal and two or four earthing screws. Temperature: -40°C to +125°C

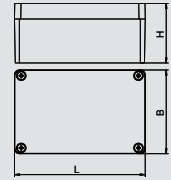

Aluminium empty housing Mx15 powder coated

Type	Length	Width	Height	Colour	Pack.	Weight	Item No.
	mm	mm	mm		pcs	kg/100 pcs.	
Mx 151008 SGR	150	100	80	Silver grey	1	81.800	2011 31 6

AIG Cast aluminium **P** Powder-coated

Robust aluminium empty housing for mechanical engineering and automation technology. The OBO Mx series' excellent mechanical and thermal features make it most suitable for extreme demands in many different areas. It is therefore also best suited for applications in industry, ports and shipbuilding, as well as in the agricultural sector. The products protect the electrical installation against high-grade strains. They withstand both extreme cold and heat as well as vandalism and impact on roads, railways or in tunnels. With an IP66 protection class, they are optimally protected against the intrusion of dust and water. The aluminium housings are plastic coated (RAL 7035) and are delivered with a cover including stainless steel screws, a seal and two or four earthing screws. Temperature: -40°C to +125°C

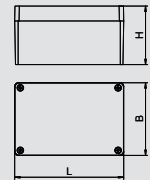

Aluminium empty housing Mx16 powder coated

Type	Length	Width	Height	Colour	Pack.	Weight	Item No.
	mm	mm	mm		pcs	kg/100 pcs.	
Mx 161609 SGR	160	160	90	Silver grey	1	146.300	2011 32 0

AIG Cast aluminium **P** Powder-coated

Robust aluminium empty housing for mechanical engineering and automation technology. The OBO Mx series' excellent mechanical and thermal features make it most suitable for extreme demands in many different areas. It is therefore also best suited for applications in industry, ports and shipbuilding, as well as in the agricultural sector. The products protect the electrical installation against high-grade strains. They withstand both extreme cold and heat as well as vandalism and impact on roads, railways or in tunnels. With an IP66 protection class, they are optimally protected against the intrusion of dust and water. The aluminium housings are plastic coated (RAL 7035) and are delivered with a cover including stainless steel screws, a seal and two or four earthing screws. Temperature: -40°C to +125°C

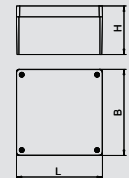

Aluminium empty housing Mx17 powder coated

Type	Length	Width	Height	Colour	Pack.	Weight	Item No.
	mm	mm	mm		pcs	kg/100 pcs.	
Mx 170805 SGR	175	80	57	Silver grey	1	53.900	2011 32 4

AIG Cast aluminium **P** Powder-coated

Robust aluminium empty housing for mechanical engineering and automation technology. The OBO Mx series' excellent mechanical and thermal features make it most suitable for extreme demands in many different areas. It is therefore also best suited for applications in industry, ports and shipbuilding, as well as in the agricultural sector. The products protect the electrical installation against high-grade strains. They withstand both extreme cold and heat as well as vandalism and impact on roads, railways or in tunnels. With an IP66 protection class, they are optimally protected against the intrusion of dust and water. The aluminium housings are plastic coated (RAL 7035) and are delivered with a cover including stainless steel screws, a seal and two or four earthing screws. Temperature: -40°C to +125°C

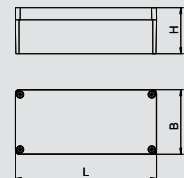

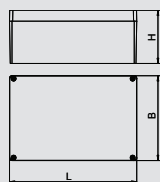

Aluminium empty housing Mx24 powder coated



Type	Length	Width	Height	Colour	Pack.	Weight	Item No.
	mm	mm	mm		pcs	kg/100 pcs.	
Mx 241610 SGR	240	160	100	Silver grey	1	197.300	2011 32 8

AIG Cast aluminium **P** Powder-coated

Robust aluminium empty housing for mechanical engineering and automation technology. The OBO Mx series' excellent mechanical and thermal features make it most suitable for extreme demands in many different areas. It is therefore also best suited for applications in industry, ports and shipbuilding, as well as in the agricultural sector. The products protect the electrical installation against high-grade strains. They withstand both extreme cold and heat as well as vandalism and impact on roads, railways or in tunnels. With an IP66 protection class, they are optimally protected against the intrusion of dust and water. The aluminium housings are plastic coated (RAL 7035) and are delivered with a cover including stainless steel screws, a seal and two or four earthing screws. Temperature: -40°C to +125°C

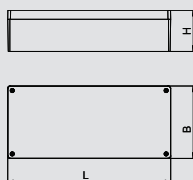

Aluminium empty housing Mx36 powder coated



Type	Length	Width	Height	Colour	Pack.	Weight	Item No.
	mm	mm	mm		pcs	kg/100 pcs.	
Mx 361609 SGR	360	160	90	Silver grey	1	273.300	2011 33 2

AIG Cast aluminium **P** Powder-coated

Robust aluminium empty housing for mechanical engineering and automation technology. The OBO Mx series' excellent mechanical and thermal features make it most suitable for extreme demands in many different areas. It is therefore also best suited for applications in industry, ports and shipbuilding, as well as in the agricultural sector. The products protect the electrical installation against high-grade strains. They withstand both extreme cold and heat as well as vandalism and impact on roads, railways or in tunnels. With an IP66 protection class, they are optimally protected against the intrusion of dust and water. The aluminium housings are plastic coated (RAL 7035) and are delivered with a cover including stainless steel screws, a seal and two or four earthing screws. Temperature: -40°C to +125°C



Junction box, aluminium

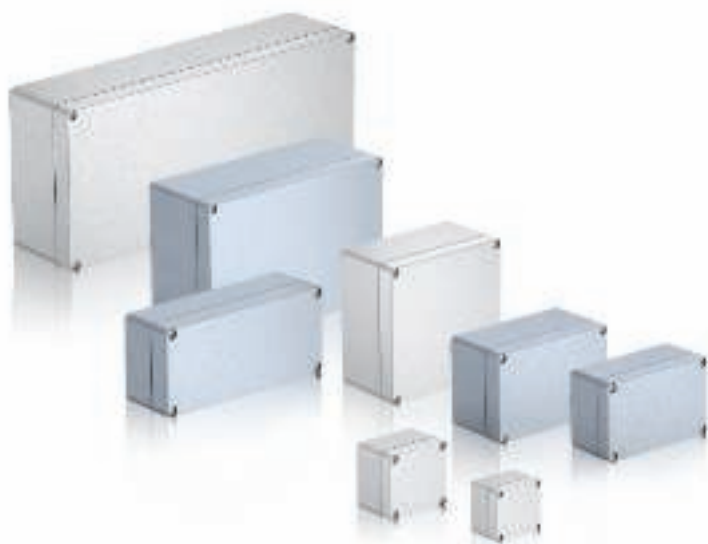

**IP
66**

- Robust aluminium empty housing for mechanical engineering and automation technology
- Suitable for extreme strains in all different areas
- Application in industry, ports and shipbuilding as well as in the agricultural sector
- With a protection class of up to IP66, they are optimally protected against the intrusion of water
- Aluminium is UV-resistant and halogen-free. The cover seal is made from polyurethane.



Aluminium empty housing Mx06 sandblasted

Type	Length	Width	Height	Pack.	Weight	Item No.
	mm	mm	mm		pcs	
Mx 060503 SGT	64	58	36	1	13.500	2011 34 4

AIG Cast aluminium sandblasted

Robust aluminium empty housing for mechanical engineering and automation technology. The OBO Mx series' excellent features make it most suitable for extreme demands in all different areas. It is therefore also best suited for applications in industry, ports and shipbuilding, as well as in the agricultural sector. The series' properties protect the electrical installation when under extreme strain. The products withstand both great cold and heat as well as impacts or kicks on roads, railways or in tunnels. With a protection class of up to IP 66, they are optimally protected against the intrusion of water. The aluminium is of course UV-resistant and halogen-free. The cover seal is made from polyurethane. The aluminium housings are sandblasted and are delivered with a cover including stainless steel screws, a seal and two or four earthing screws. The surface provides a good contact when using metal fittings.

Temperature: -40°C to +125°C

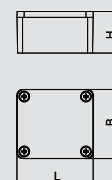

Aluminium empty housing Mx08 sandblasted

Type	Length	Width	Height	Pack.	Weight	Item No.
	mm	mm	mm		pcs	
Mx 080705 SGT	80	75	57	1	30.600	2011 34 8

AIG Cast aluminium sandblasted

Robust aluminium empty housing for mechanical engineering and automation technology. The OBO Mx series' excellent features make it most suitable for extreme demands in all different areas. It is therefore also best suited for applications in industry, ports and shipbuilding, as well as in the agricultural sector. The series' properties protect the electrical installation when under extreme strain. The products withstand both great cold and heat as well as impacts or kicks on roads, railways or in tunnels. With a protection class of up to IP 66, they are optimally protected against the intrusion of water. The aluminium is of course UV-resistant and halogen-free. The cover seal is made from polyurethane. The aluminium housings are sandblasted and are delivered with a cover including stainless steel screws, a seal and two or four earthing screws. The surface provides a good contact when using metal fittings.

Temperature: -40°C to +125°C

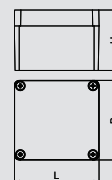

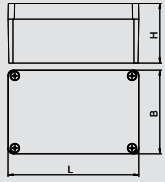

Aluminium empty housing Mx12 sandblasted



Type	Length	Width	Height	Pack.	Weight	Item No.
	mm	mm	mm	pcs	kg/100 pcs.	
Mx 120805 SGT	125	80	57	1	45.600	2011 35 2

AIG Cast aluminium sandblasted

Robust aluminium empty housing for mechanical engineering and automation technology. The OBO Mx series' excellent features make it most suitable for extreme demands in all different areas. It is therefore also best suited for applications in industry, ports and shipbuilding, as well as in the agricultural sector. The series' properties protect the electrical installation when under extreme strain. The products withstand both great cold and heat as well as impacts or kicks on roads, railways or in tunnels. With a protection class of up to IP 66, they are optimally protected against the intrusion of water. The aluminium is of course UV-resistant and halogen-free. The cover seal is made from polyurethane.

The aluminium housings are sandblasted and are delivered with a cover including stainless steel screws, a seal and two or four earthing screws. The surface provides a good contact when using metal fittings.

Temperature: -40°C to +125°C

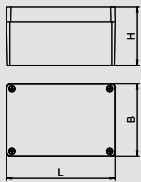

Aluminium empty housing Mx15 sandblasted



Type	Length	Width	Height	Pack.	Weight	Item No.
	mm	mm	mm	pcs	kg/100 pcs.	
Mx 151008 SGT	150	100	80	1	81.800	2011 35 6

AIG Cast aluminium sandblasted

Robust aluminium empty housing for mechanical engineering and automation technology. The OBO Mx series' excellent features make it most suitable for extreme demands in all different areas. It is therefore also best suited for applications in industry, ports and shipbuilding, as well as in the agricultural sector. The series' properties protect the electrical installation when under extreme strain. The products withstand both great cold and heat as well as impacts or kicks on roads, railways or in tunnels. With a protection class of up to IP 66, they are optimally protected against the intrusion of water. The aluminium is of course UV-resistant and halogen-free. The cover seal is made from polyurethane.

The aluminium housings are sandblasted and are delivered with a cover including stainless steel screws, a seal and two or four earthing screws. The surface provides a good contact when using metal fittings.

Temperature: -40°C to +125°C

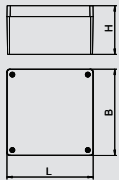

Aluminium empty housing Mx16 sandblasted



Type	Length	Width	Height	Pack.	Weight	Item No.
	mm	mm	mm	pcs	kg/100 pcs.	
Mx 161609 SGT	160	160	90	1	146.300	2011 36 0

AIG Cast aluminium sandblasted

Robust aluminium empty housing for mechanical engineering and automation technology. The OBO Mx series' excellent features make it most suitable for extreme demands in all different areas. It is therefore also best suited for applications in industry, ports and shipbuilding, as well as in the agricultural sector. The series' properties protect the electrical installation when under extreme strain. The products withstand both great cold and heat as well as impacts or kicks on roads, railways or in tunnels. With a protection class of up to IP 66, they are optimally protected against the intrusion of water. The aluminium is of course UV-resistant and halogen-free. The cover seal is made from polyurethane.

The aluminium housings are sandblasted and are delivered with a cover including stainless steel screws, a seal and two or four earthing screws. The surface provides a good contact when using metal fittings.

Temperature: -40°C to +125°C

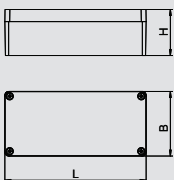

Aluminium empty housing Mx17 sandblasted



Type	Length	Width	Height	Pack.	Weight	Item No.
	mm	mm	mm	pcs	kg/100 pcs.	
Mx 170805 SGT	175	80	57	1	53.900	2011 36 4

AIG Cast aluminium sandblasted

Robust aluminium empty housing for mechanical engineering and automation technology. The OBO Mx series' excellent features make it most suitable for extreme demands in all different areas. It is therefore also best suited for applications in industry, ports and shipbuilding, as well as in the agricultural sector. The series' properties protect the electrical installation when under extreme strain. The products withstand both great cold and heat as well as impacts or kicks on roads, railways or in tunnels. With a protection class of up to IP 66, they are optimally protected against the intrusion of water. The aluminium is of course UV-resistant and halogen-free. The cover seal is made from polyurethane.

The aluminium housings are sandblasted and are delivered with a cover including stainless steel screws, a seal and two or four earthing screws. The surface provides a good contact when using metal fittings.

Temperature: -40°C to +125°C



Junction box, aluminium



Aluminium empty housing Mx24 sandblasted



Type	Length mm	Width mm	Height mm	Pack. pcs	Weight kg/100 pcs.	Item No.
Mx 241610 SGT	240	160	100	1	197.300	2011 36 8

AIG Cast aluminium sandblasted

Robust aluminium empty housing for mechanical engineering and automation technology. The OBO Mx series' excellent features make it most suitable for extreme demands in all different areas. It is therefore also best suited for applications in industry, ports and shipbuilding, as well as in the agricultural sector. The series' properties protect the electrical installation when under extreme strain. The products withstand both great cold and heat as well as impacts or kicks on roads, railways or in tunnels. With a protection class of up to IP 66, they are optimally protected against the intrusion of water. The aluminium is of course UV-resistant and halogen-free. The cover seal is made from polyurethane.

The aluminium housings are sandblasted and are delivered with a cover including stainless steel screws, a seal and two or four earthing screws. The surface provides a good contact when using metal fittings.

Temperature: -40°C to +125°C

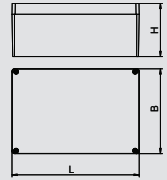

Aluminium empty housing Mx36 sandblasted



Type	Length mm	Width mm	Height mm	Pack. pcs	Weight kg/100 pcs.	Item No.
Mx 361609 SGT	360	160	90	1	273.300	2011 37 2

AIG Cast aluminium sandblasted

Robust aluminium empty housing for mechanical engineering and automation technology. The OBO Mx series' excellent features make it most suitable for extreme demands in all different areas. It is therefore also best suited for applications in industry, ports and shipbuilding, as well as in the agricultural sector. The series' properties protect the electrical installation when under extreme strain. The products withstand both great cold and heat as well as impacts or kicks on roads, railways or in tunnels. With a protection class of up to IP 66, they are optimally protected against the intrusion of water. The aluminium is of course UV-resistant and halogen-free. The cover seal is made from polyurethane.

The aluminium housings are sandblasted and are delivered with a cover including stainless steel screws, a seal and two or four earthing screws. The surface provides a good contact when using metal fittings.

Temperature: -40°C to +125°C

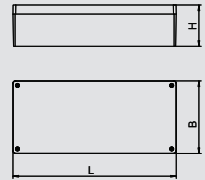

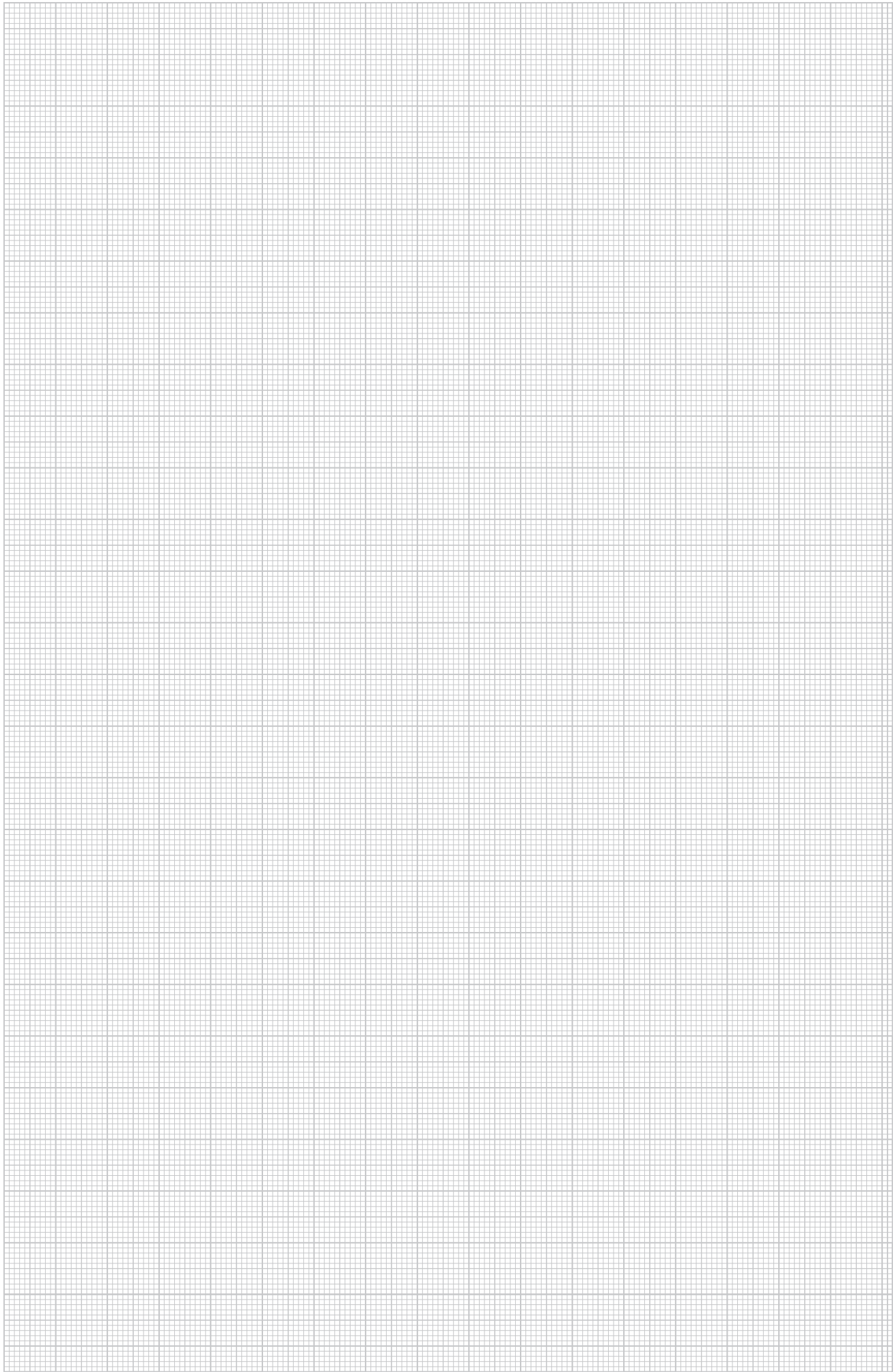

OBO BETTERMANN GmbH & Co. KG

P.O. Box 1120
58694 Menden, Germany

Customer Service Germany

Tel. +49 (0)2373 89-1700
Fax +49 (0)2373 89-1238
E-mail: export@obo.de

www.obo-bettermann.com

THINK CONNECTED.

